

Relevant Information for Council

FILE: X038100 **DATE:** 23 July 2021

TO: Lord Mayor and Councillors

FROM: Amit Chanan, Director City Projects and Properties

THROUGH: Monica Barone, Chief Executive Officer

SUBJECT: Information Relevant To Item 7.4 - Project Scope - Harry Noble Reserve Playground, Erskineville

For Noting

This memo is for the information of the Lord Mayor and Councillors.

Purpose

The purpose is to provide information about the recently installed planting under the trees and provide further drawings of the proposed active recreation courts/facilities and proposed barriers and fences.

Background

At the meeting of the Environment Committee on 19 July 2021, further information was sought by Councillors about:

1. Provide further detail/clearer drawings outlining the proposed fencing.
2. Provide further information/drawings on the proposed sporting courts/facilities (netball/basketball etc.)
3. Provide further information on the under-tree plantings (replacing wood chips/mulch) which has reduced accessible open space

Proposed Barriers and Fences - The proposal relocates the playground to improve the connection with the picnic facilities, social gathering, and open grass areas. This also allows the provision of new active recreation courts. The design includes a fully fenced and enclosed toddler playground area, low barrier seating walls and planted areas with barrier fences. A high netted fence will also be provided next to the courts to provide ball protection to adjacent properties - refer Attachment A. The aim is to improve usability and maintain the open and flexible park with separation and clearly defined spaces for dog off-leash and other park uses.

A sandstone edge wall and fences surround the park.

Active Recreation Facilities - The proposal increases the active recreation facilities and improves usability. The proposed location maximises the distance from residential dwellings and the protected corner location helps minimise disturbance to other park users. The design includes new active recreation court area with two new basketball goal circles, hoop and backboard, one netball half court and one goal circle practice area - refer Attachment A.

The existing cricket pitch and central open grass area will be retained.

Under-tree plantings - The low ground cover and shrub planting were installed in late April and May 2021 as part of ongoing maintenance and minor improvements works.

Due to the existing mature trees surrounding the park and overshadowing large areas under the trees are mulch. New green and colourful shrub plants were installed to improve the park amenity. This is like other City parks such as Redfern Park and Oval.

The open grass areas were not reduced by these new under tree shrub planting. Temporary fences have been installed as protection, until the plants are establishment.

No additional planting is proposed in the mulch understory areas as part of Harry Noble Reserve Playground works.

Memo from Amit Chanan, Director City Projects and Properties

Prepared by: Stephen Merchant, Senior Design Manager

Attachments

Attachment A. Active Recreation and Barrier / Fences Plan and City of Sydney Standard Playground Fence Design

Approved

A handwritten signature in black ink, appearing to read 'P.M. Barone', with a long horizontal flourish extending to the right.

MONICA BARONE

Chief Executive Officer

Attachment A

Active Recreation and Barrier/ Fences Plan

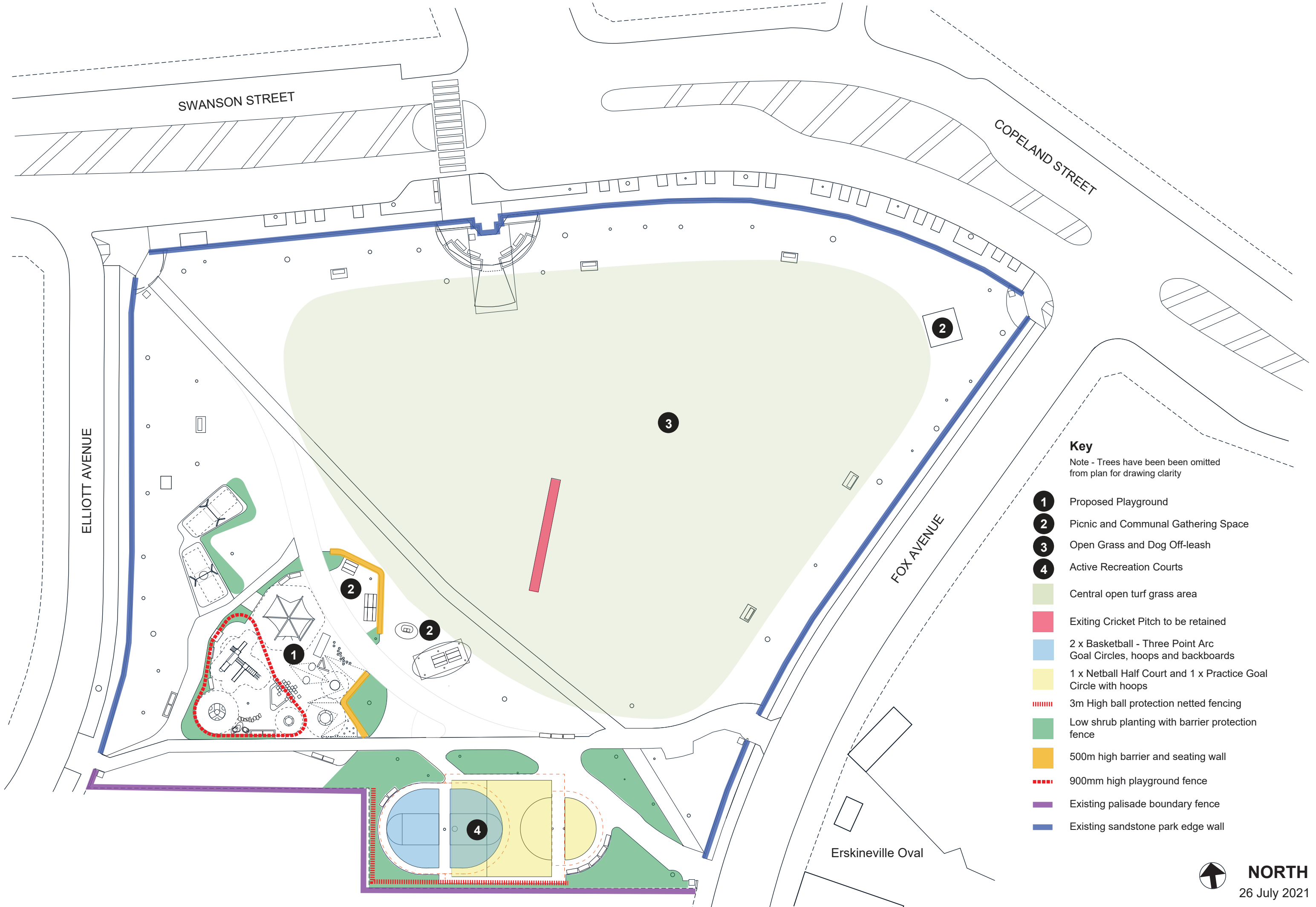

Harry Noble Reserve Playground - Active Recreation & Barriers/ Fence Plan

Standard City Playground Fence Design

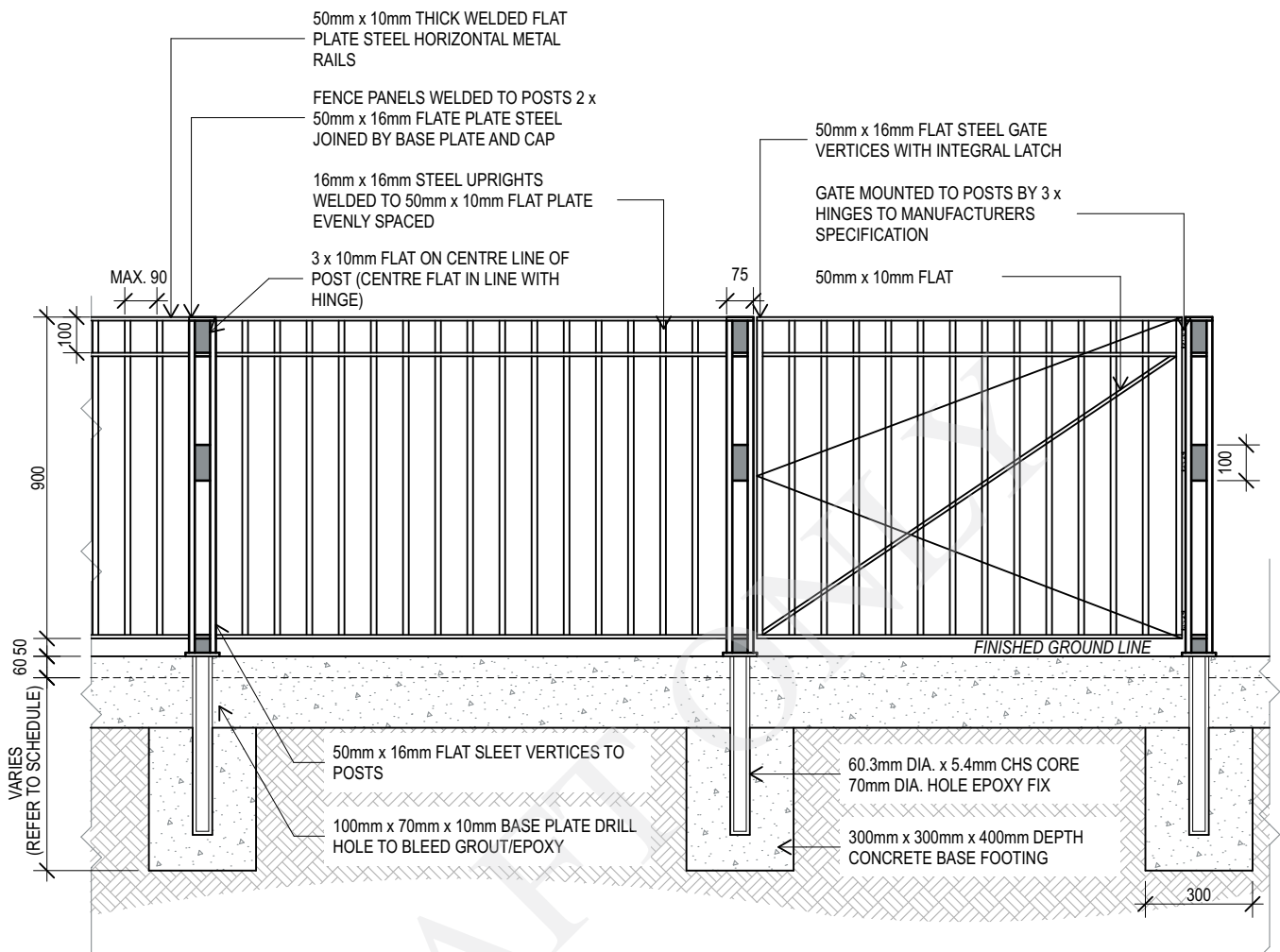

PAINT FINISH:
1) MICACEOUS GREY - PREFERRED
TYPICAL
2) BLACK IF MATCHING EXISTING BLACK
FURNITURE
3) DULUX METROPOLIS BRONZE PEARL
SATIN 971-59003 IF MATCHING INTO THE
PUBLIC DOMAIN

FOOTING DEPTH SCHEDULE

SOIL	DEPTH
LOOSE SAND, SOFT CLAY	750mm
STIFF CLAY	600mm
FILL	900mm

SECTION

0 200 400 800mm
SCALE 1:20@A4 REV.C 30.09.2016

General design notes:

- All metal work to be painted with natural grey micaceous iron oxide
- Gate width to be confirmed with council. 1200mm minimum.
- Fence to rake up slopes. No stepping. Posts and up rights to be vertical, not perpendicular to slope.
- Shop drawings to be provided prior to construction.
- if gate is to be locked use KA2 keyed lock in northern area parks and PTK

keyed lock in southern area

