

# **Attachment A**

**Deposited Plan 732639**

PLAN FORM 2  
 Structures and Area Only

Plan Drawing only to appear in this space

Db 135838

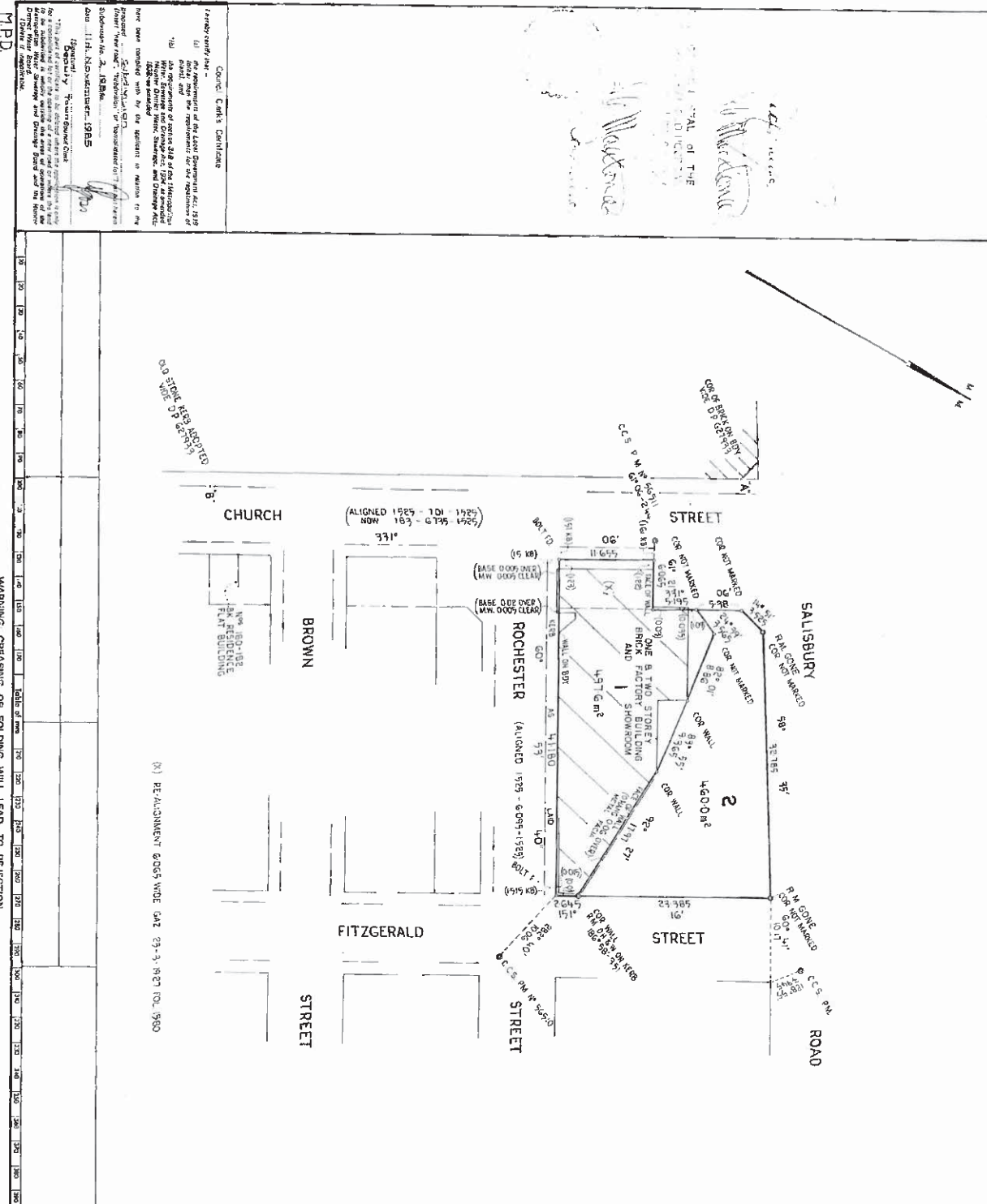

MPD

Control Clerk's Certificate  
 I hereby certify that the above mentioned plans and specifications for the proposed works have been approved by me in accordance with the provisions of the Municipalities Act, 1958 and the regulations made thereunder.  
 Signed: \_\_\_\_\_  
 Date: 11th November, 1985

WARNING CHEASING OR FOLDING WILL LEAD TO REJECTION

This negative is a photograph made as a permanent record of a document in the custody of the Registrar General, this day, 2nd May, 1986



D.P. 732639 1-5-1986 CA No 27/1986 OF 11 1985 TORRENS SLURVISON Ref Map ROLL PLAN 12 Lot Plan 6015(L) #	OF SYDNEY CAMPERDOWN PETERSHAM CUMBERLAND	PLAN OF LOT 21 & 22 IN PRIMARY APPLICATION NO 27/1986 & LOT 22 IN PRIMARY APPLICATION NO 27/1986 BEING THE LAND IN CERTIFICATE OF TITLE VOL 5194 FOL 119 & VOL 1400 FOL 139 RESPECTIVELY
Signature: _____ Date: 11th November 1985	I, MICHAEL C. WHELAN of 63 YORK ST. SYDNEY, NSW 2000 do hereby certify that the above mentioned plans and specifications for the proposed works have been approved by me in accordance with the provisions of the Municipalities Act, 1958 and the regulations made thereunder. Signed: _____ Date: 11th November 1985	DEFINITION OF SALISBURY RD FITZGERALD COUNCIL'S BOUNDARIES AS APPLICABLE BY THE COUNCIL OF THE CITY OF SYDNEY

Db 135838

1  
2  
3  
4  
5  
6  
7  
8  
9  
10  
11  
12