

Michael Buble Concert – Friday 5 October 2018

Moore Park Rd Over
Attachment 1.3

Version Date: 10 August 2018

Key Timings:

- Gates Open: 5:00PM
- Support Act: 6:00PM tbc
- Michael Buble: 7:30PM
- Approximate Finish Time: 10:30PM

EGRESS PHASE:
9:30PM – 11:30PM

CONTINGENCY: Moore Park Eastbound to be closed, at the discretion of TMC and Police. TMC Commander vehicle will be located at Greens Rd on standby to implement closure if required. (usually if concert crowd is >30,000)

If contingency closure is implemented, contingency closure of Greens Rd at Josephson St and Moore Park Rd will be implemented by a standby traffic controller to minimise vehicles on Moore Park Rd.

Left Turn from Flinders St will still be permitted in order to move vehicles out of Bus Lane so bus movements are maintained.

Consideration for Taxi & Uber Drop-off area, Anzac Parade Lane 1 southbound, with 40km/hr speed reduction. tbc

Eastern Distributor exit CLOSED from 9:30PM by ED at request from TMC.

Managed Ped crossing to reduce Ped crossing demands at Driver Ave. Police to manage vehicles, Traffic Controllers manage pedestrians.

MP Rd Plan A: If crowd >30,000 Police & TMC to make a decision by 8PM to close MP Rd Eastbound **Plan A:** is the preferred Option at approx. 10:25PM. Then; 1. Westbound closure may not need to go in until 10PM and, 2. The main runs of CCB can be removed and stacked on the southern footpath. 50-80m of CCB remain East of Driver to help control westbound Ped flows. CCB removed by Contractor from 11PM

Mp Rd Plan B: If crowd <30,000 Police & TMC to make a decision by 8PM NOT to close MP Rd Eastbound. Then main runs of CCB will be relocated out to median after road closed at 9:30PM. Then removed by Contractor from 11PM

Moore Park Road Closed (Westbound) at Oxford St from 9:30PM – 11:30PM. TCP Phase 'B2' will allow Local Access only from Oxford St to Lang Rd & Cook Rd. TCP Phase 'B' will be a full westbound closure and will be implemented if requested by Police.

Regent St and Gordon St access closed from Moore Park Rd (LOCAL ACCESS ONLY)

Gates E, H & G, exit via Moore Park Road Stairs

Gate I, Back of Floor and possibly Gate H to exit via Tractor Chute ingress to SCG Gate A on to Driver Ave.

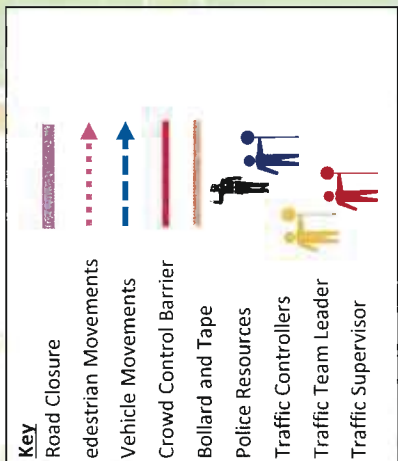

Pedestrian movements will be favoured over vehicle movements from Car Park for the first 15-20min of Egress. If MP Rd closed Eastbound then Police must force left turn only from Driver for first 20-30min of egress.

Gates A, C, K egress via Allianz Forecourt to Driver Avenue

