

- Manifest**
- 1 x all terrain 5 axle
 - 6 x Barrel
 - 94 x Cone
 - 1 x franna
 - 1 x ImRIGHTARROW
 - 1 x R4-1 40 kph
 - 1 x semi trailer
 - 4 x Sign
 - 2 x T1-18 prepare to stop
 - 2 x T1-200-2" traffic controller ahead symbolic day (yellow)
 - 4 x T1-5-2 " workers ahead symbolic day
 - 2 x T1-6 detour ahead
 - 1 x T2-4 road closed
 - 2 x T2-Q02a road closed ahead T2-Q02a
 - 1 x T5-1 (R) detour (R)
 - 2 x T5-1* detour (S)
 - 8 x T5-5 T5-5 single chevron
 - 2 x T8-2L pedestrians (L)
 - 2 x T8-2R pedestrians (R)
 - 4 x T8-3 use other footpath
 - 24 x traffic light

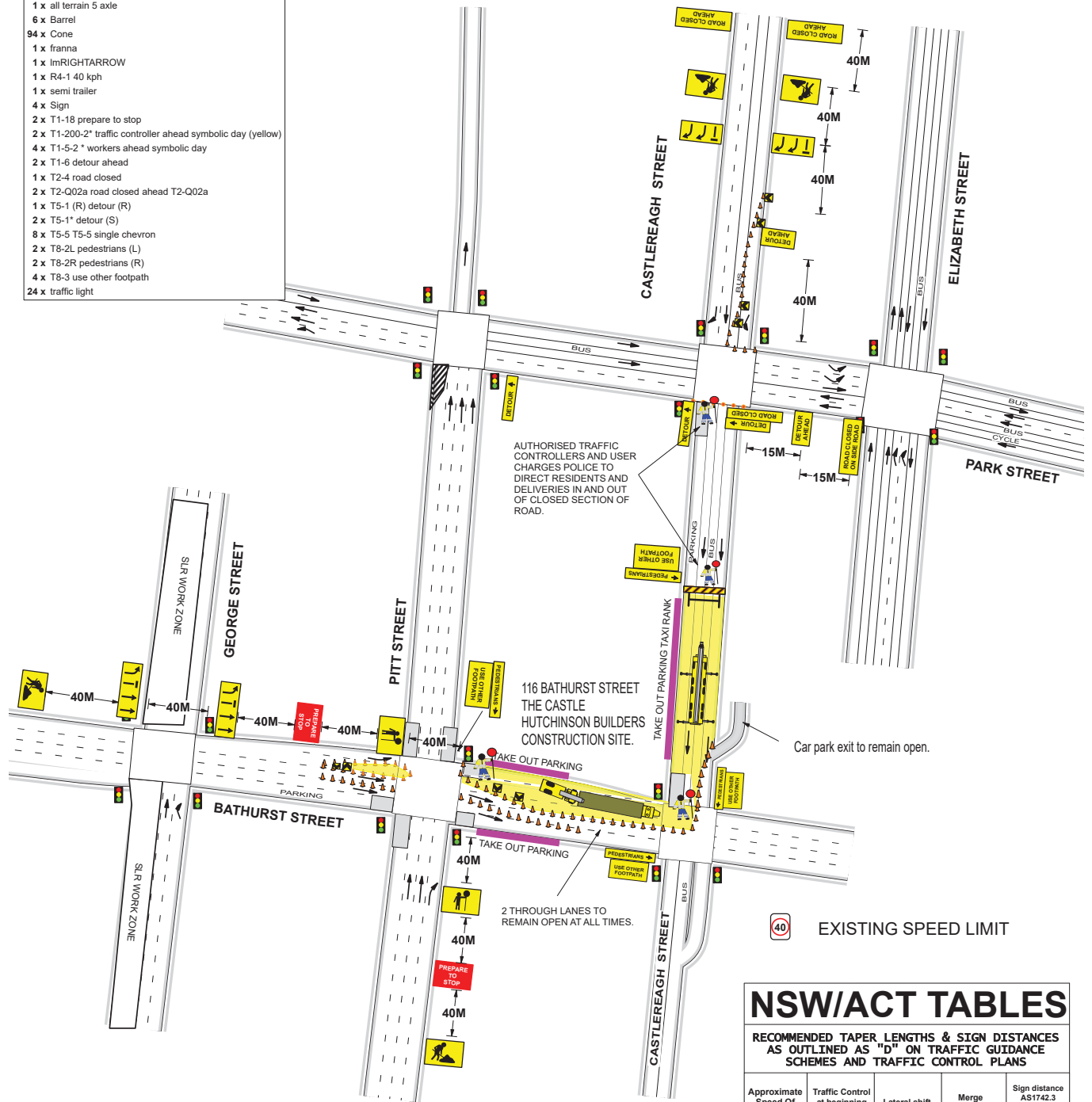

NSW/ACT TABLES

RECOMMENDED TAPER LENGTHS & SIGN DISTANCES AS OUTLINED AS "D" ON TRAFFIC GUIDANCE SCHEMES AND TRAFFIC CONTROL PLANS

Approximate Speed Of Traffic	Traffic Control at beginning of Taper	Lateral shift taper	Merge taper	Sign distance AS1742.3 & TCAWS
45 or Less	15	0	15	40km/hr 5m or 40m
46 - 55	15	15	30	50km/hr 15m or 50m
56 - 65	30	30	60	60km/hr 45m or 60m
66 - 75	N/A	70	115	70km/hr 70m
76 - 85	N/A	80	130	80km/hr 80m
86 - 95	N/A	90	145	90km/hr 90m
96 - 105	N/A	100	160	100km/hr 100m
Greater than 105	N/A	110	180	110km/hr 110m

DANGER
LOOK UP & LIVE
KEEP CLEAR OF ALL OVERHEAD ELECTRICAL HAZARDS

Lack Group
K & D Traffic Management
2/13 Stanton Rd,
Seven Hills NSW 2147
P: 02-96627113
email: lgp@lackgroup.com.au

Traffic control works shall be installed & maintained in accordance with Australian Standard 1742.3 (Traffic Control Devices for Work on Roads) &/or RTA Traffic Control at Work Sites Manual Version 4 June 2010.
Local constraints may not allow sign and devices to be placed exactly in accordance with the TCP judgement, therefore it may be necessary to place sign and devices as close as possible to the spacing indicated.
Signs spacing measurements may extend across some intersections, therefore warning signs may need to be placed in the side streets.
Signs should generally be placed 1 metre clear of the travelled path.
Signs are to be Class 1 retro-reflective (day/night), positioned adjacent to footpath or where vehicle parking occurs place signs in the parking lane or elevated on posts. They must be positioned so that they are in clear view of passing motorists.
At the end of the work, or when traffic controllers are absent for an extended period, the T1-18 and T1-200 signs shall be removed.
When traffic controllers are not controlling vehicles they are to control pedestrians on a hold and release basis as work on site dictates.

NOT TO SCALE

TOP BEST VIEWED WHEN PRINTED IN A3

Client: Reds Global
Location: 116 Bathurst Street Sydney
Description: Tower Crane Install
Plan Number: 0985-2018
Date drawn: 20/07/2018
Authorised by:
Qualification:
Signature: P. Turner
Date:
Revision 1:
Revision 2:
Revision 3:
Revision 4:
Revision 5:
DRAWN BY: Peter Turner
PREPARE WORKZONE TMP #:0036129415
www.inticert.com