

Date: 17/04/2019 Author: Darren Lindsay Project: Underwood & Dalley Street, Sydney CBD Road Closure
Client: Delta Group Contact: Angus Lumsden Phone : 0431 501 281
Plan Number: 0483 Road Closure



Comments:

This plan was designed by Darren Lindsay of Sydney Traffic Control in accordance with Australian Standards and the RMS's Traffic Control on Worksite Handbook Version 4.0. The plan is designed for the safe setup of a mobile crane in Dalley Street for the lifting of materials onto property 210-220 George Street, Sydney. Certified Traffic Controllers will be on site to implement and monitor this TCP. Sydney Traffic Control holds no responsibility for this TCP unless Sydney Traffic Control employees are used to implement and monitor this TCP. All traffic control plans are copyright/property of Sydney Traffic Control and are not transferable unless authorized by Sydney Traffic Control. Any question please contact Craig Reeves of Sydney Traffic Control on 80681844 or 0451114280.

NSW Transport Roads & Maritime Services
 Traffic & Work Zone Traffic Management Plan
 This qualification enables you to apply Traffic Management Plans and Traffic Management Plans

DARREN LINDSAY
 Issued from 03/04/2020



The above is valid until 03/04/2021

Legend

- sign single
- traffic light
- Mobile Crane
- Overhead walkway
- Exclusion Zone
- SLR work area
- Property
- Pedestrian route
- Traffic Controller
- Barrier
- barrier position
- Metered parking

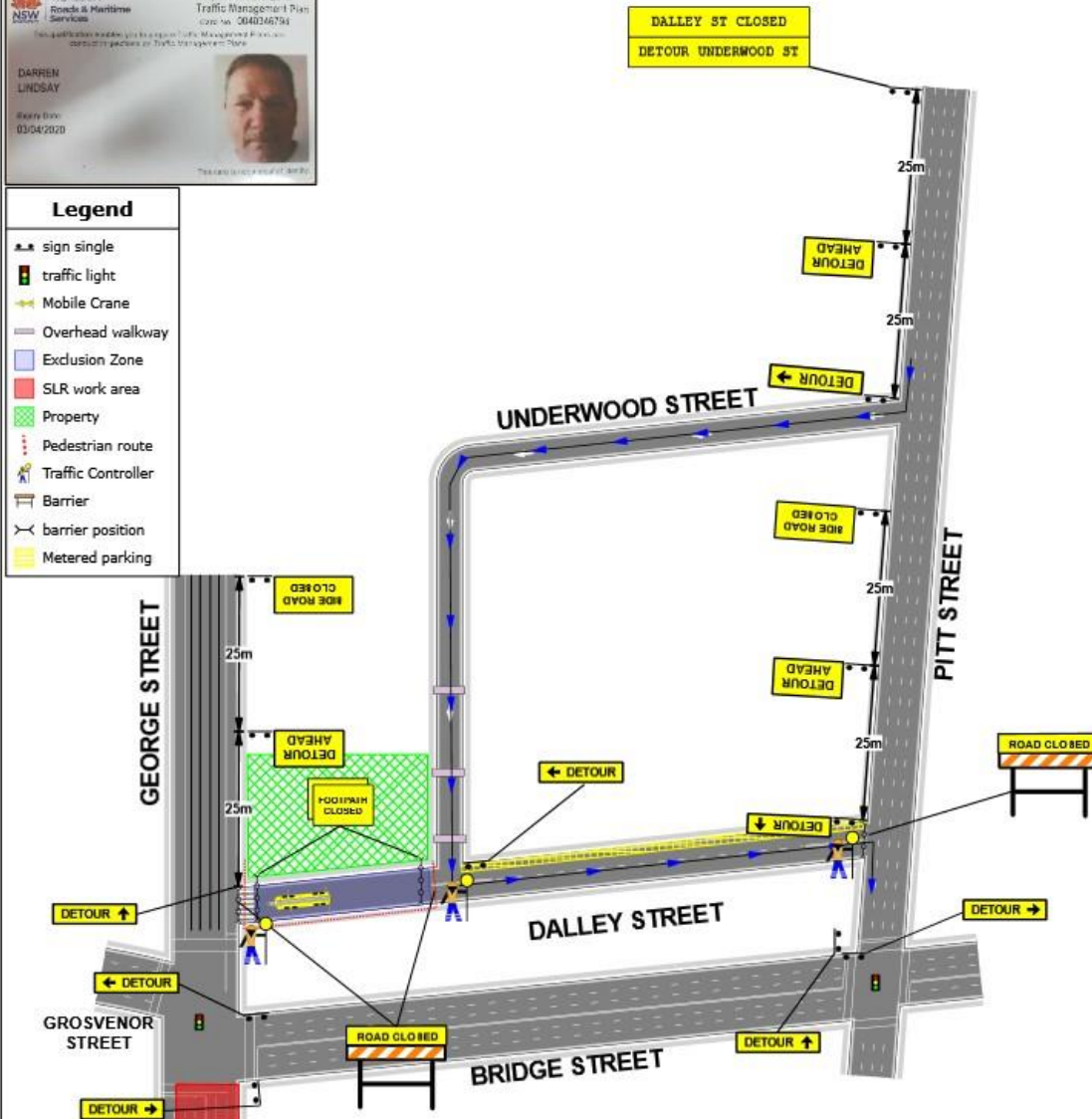

ALL SIGNS AND SPACING MUST BE IN ACCORDANCE WITH AUSTRALIAN STANDARD 1742-3

PLAN NOT TO SCALE