

Attachment B

Consultation Concept Plan



Proposed works

- 01** Remove 4 trees to reduce structural impacts on wall and improve pedestrian safety
- 02** New sandstone clad retaining wall to replace existing wall - 700mm high
- 03** New wider steps in line with opposite laneway including handrails and lighting to improve accessibility
- 04** New paving
- 05** New robust planting throughout garden beds to improve amenity
- 06** Existing footpath retained in middle section of laneway

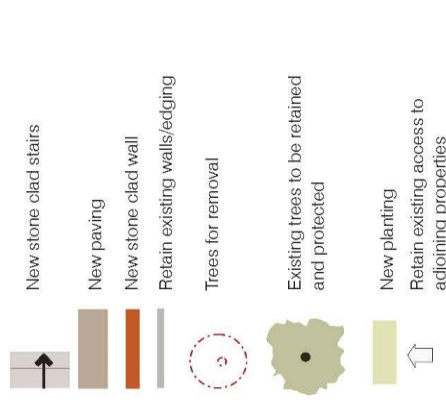

Existing site condition from Thomson Street



Existing site condition from Bourke Street