

# **Attachment C1**

<b>Selected Drawings</b>
--------------------------

I, the undersigned, being a duly qualified Architect, hereby certify that I am the author of the design and drawings hereon set forth, and that I am not aware of any other person claiming to be the author of the same.

The undersigned Architect, Adam Holburn 2188 | John Pringle 7004

# FOR APPROVAL

Rev	Date	Revision	By	CHK.
1	24.06.2019	ISSUED FOR INFORMATION	BR	NH
2	26.06.2019	ISSUED FOR CA	BR	NH
3	27.06.2019	ISSUED FOR CA	BR	NH
4	27.07.2019	ISSUED FOR CA	BR	NH
5	28.07.2019	FINAL ISSUE FOR CA	BR	NH

- Site
- Open space
- Traffic noise
- No solar access
- Active edges
- Residential
- Future light rail

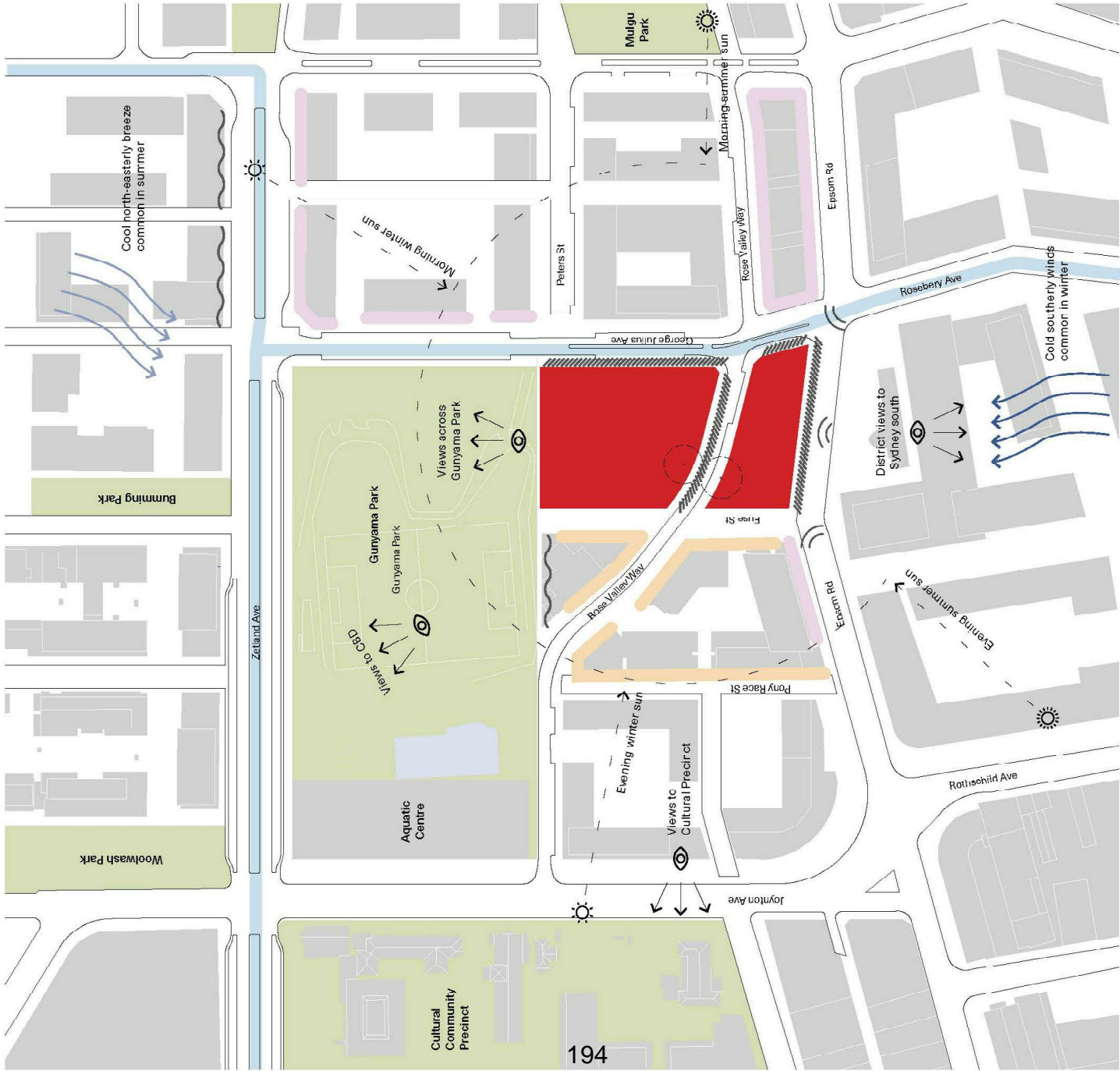

Site Key



Client



Project  
Epsom Rd  
94 - 104 Epsom Road, Zetland

Drawing Name  
Site Analysis

Date	Scale	Sheet Size
26.07.2019	1 : 1000	@ A1
Drawn	CHK.	
BR	NH	
Sub No.	Drawing No.	Revision
	5997	DA-0102 / 5

33 Architects  
400 Crown Street  
Sydney NSW 2000  
2010 Australia  
P 61 2 9388 9822  
www.33a.com.au

In accepting and affixing this document the recipient agrees that 3JB Architects Pty Ltd is not responsible for any errors or omissions in this document. The recipient is responsible for ensuring that the information in this document is accurate and complete. The recipient is responsible for ensuring that the information in this document is accurate and complete. The recipient is responsible for ensuring that the information in this document is accurate and complete.

FOR APPROVAL

Rev	Date	Revision	By	CHK
1	21.06.2019	ISSUED FOR BIDDING	BR	HA
2	21.06.2019	ISSUED FOR COORDINATION	BR	HA
3	21.06.2019	ISSUED FOR COORDINATION	BR	HA
4	21.06.2019	ISSUED FOR DA	BR	HA
5	03.07.2019	ISSUED FOR DA	BR	HA
6	03.07.2019	ISSUED FOR DA	BR	HA
7	26.07.2019	FINAL ISSUE FOR DA	BR	HA
8	14.02.2020	ISSUE FOR COORDINATION	BR	HA
9	14.02.2020	ISSUE FOR COORDINATION	BR	HA
10	17.02.2020	ISSUE FOR COORDINATION	BR	HA

3JB Architects Pty Ltd  
100/102 Epsom Road, Epsom  
Auckland 1060, New Zealand  
Phone: +64 9 276 1234  
Fax: +64 9 276 1235  
Email: info@3jb.co.nz  
Website: www.3jb.co.nz

Parking Schedule

Item	Area (m <sup>2</sup> )	Vehicle Type	Count
1	1,100	Standard Car	10
2	1,100	Standard Car	10
3	1,100	Standard Car	10
4	1,100	Standard Car	10
5	1,100	Standard Car	10
6	1,100	Standard Car	10
7	1,100	Standard Car	10
8	1,100	Standard Car	10
9	1,100	Standard Car	10
10	1,100	Standard Car	10
11	1,100	Standard Car	10
12	1,100	Standard Car	10
13	1,100	Standard Car	10
14	1,100	Standard Car	10
15	1,100	Standard Car	10
16	1,100	Standard Car	10
17	1,100	Standard Car	10
18	1,100	Standard Car	10
19	1,100	Standard Car	10
20	1,100	Standard Car	10
21	1,100	Standard Car	10
22	1,100	Standard Car	10
23	1,100	Standard Car	10
24	1,100	Standard Car	10
25	1,100	Standard Car	10
26	1,100	Standard Car	10
27	1,100	Standard Car	10
28	1,100	Standard Car	10
29	1,100	Standard Car	10
30	1,100	Standard Car	10
31	1,100	Standard Car	10
32	1,100	Standard Car	10
33	1,100	Standard Car	10
34	1,100	Standard Car	10
35	1,100	Standard Car	10
36	1,100	Standard Car	10
37	1,100	Standard Car	10
38	1,100	Standard Car	10
39	1,100	Standard Car	10
40	1,100	Standard Car	10
41	1,100	Standard Car	10
42	1,100	Standard Car	10
43	1,100	Standard Car	10
44	1,100	Standard Car	10
45	1,100	Standard Car	10
46	1,100	Standard Car	10
47	1,100	Standard Car	10
48	1,100	Standard Car	10
49	1,100	Standard Car	10
50	1,100	Standard Car	10
51	1,100	Standard Car	10
52	1,100	Standard Car	10
53	1,100	Standard Car	10
54	1,100	Standard Car	10
55	1,100	Standard Car	10
56	1,100	Standard Car	10
57	1,100	Standard Car	10
58	1,100	Standard Car	10
59	1,100	Standard Car	10
60	1,100	Standard Car	10
61	1,100	Standard Car	10
62	1,100	Standard Car	10
63	1,100	Standard Car	10
64	1,100	Standard Car	10
65	1,100	Standard Car	10
66	1,100	Standard Car	10
67	1,100	Standard Car	10
68	1,100	Standard Car	10
69	1,100	Standard Car	10
70	1,100	Standard Car	10
71	1,100	Standard Car	10
72	1,100	Standard Car	10
73	1,100	Standard Car	10
74	1,100	Standard Car	10
75	1,100	Standard Car	10
76	1,100	Standard Car	10
77	1,100	Standard Car	10
78	1,100	Standard Car	10
79	1,100	Standard Car	10
80	1,100	Standard Car	10
81	1,100	Standard Car	10
82	1,100	Standard Car	10
83	1,100	Standard Car	10
84	1,100	Standard Car	10
85	1,100	Standard Car	10
86	1,100	Standard Car	10
87	1,100	Standard Car	10
88	1,100	Standard Car	10
89	1,100	Standard Car	10
90	1,100	Standard Car	10
91	1,100	Standard Car	10
92	1,100	Standard Car	10
93	1,100	Standard Car	10
94	1,100	Standard Car	10
95	1,100	Standard Car	10
96	1,100	Standard Car	10
97	1,100	Standard Car	10
98	1,100	Standard Car	10
99	1,100	Standard Car	10
100	1,100	Standard Car	10

Scale: 1:200

Sheet: 2/2

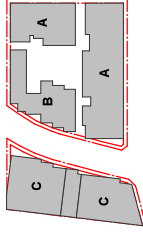

Client:



Project:

Epsom Rd

94 - 104 Epsom Road, Zeland

Drawing Name:

Floor Plan - Parking Level 2



Date: 17.03.2020  
Scale: 1:200  
Sheet Size: A1

Drawn: CH  
CHK: NH

BR: BR  
Revision: 5997 DA-0198 / 10

3JB Architects  
400 Green Street  
Auckland 1014, New Zealand  
Phone: +64 9 276 1234  
Fax: +64 9 276 1235  
Email: info@3jb.co.nz  
Website: www.3jb.co.nz

I, the undersigned, being the duly qualified and licensed Architect, hereby certify that I am the author of the design and construction documents herein, and that I am not aware of any falsification of the same, and that I am not aware of any other person's use of my name or seal in connection with the preparation of these documents.

Notwithstanding to whom the documents are submitted, I agree to hold harmless and defend the client against and from any and all claims, damages, losses and expenses, including reasonable attorneys' fees, which may be asserted against or incurred by the client in connection with the preparation of these documents, whether or not the same are caused in whole or in part by the negligence of the architect, provided that the claim, damage, loss or expense results from or is caused by or is attributable to either of the following events: (a) fraud in the execution of these documents; or (b) active or willful misfeasance, malfeasance, or neglect by the architect in the performance of professional services.

Notwithstanding to whom the documents are submitted, I agree to hold harmless and defend the client against and from any and all claims, damages, losses and expenses, including reasonable attorneys' fees, which may be asserted against or incurred by the client in connection with the preparation of these documents, whether or not the same are caused in whole or in part by the negligence of the architect, provided that the claim, damage, loss or expense results from or is caused by or is attributable to either of the following events: (a) fraud in the execution of these documents; or (b) active or willful misfeasance, malfeasance, or neglect by the architect in the performance of professional services.

# FOR APPROVAL

Rev	Date	By	CHK
1	21.06.2019	ISSUED FOR PERMIT	BR
2	21.06.2019	ISSUED FOR COORDINATION	BR
3	21.06.2019	ISSUED FOR COORDINATION	BR
4	21.06.2019	ISSUED FOR CA	BR
5	03.07.2019	ISSUED FOR CA	BR
6	03.07.2019	ISSUED FOR CA	BR
7	26.07.2019	FINAL ISSUE FOR CA	BR
8	14.02.2020	ISSUED FOR COORDINATION	BR
9	14.02.2020	ISSUED FOR COORDINATION	BR
10	17.02.2020	ISSUED FOR COORDINATION	BR

Notwithstanding to whom the documents are submitted, I agree to hold harmless and defend the client against and from any and all claims, damages, losses and expenses, including reasonable attorneys' fees, which may be asserted against or incurred by the client in connection with the preparation of these documents, whether or not the same are caused in whole or in part by the negligence of the architect, provided that the claim, damage, loss or expense results from or is caused by or is attributable to either of the following events: (a) fraud in the execution of these documents; or (b) active or willful misfeasance, malfeasance, or neglect by the architect in the performance of professional services.

Room	Area	Volume	Notes
1	1.1	1.1	1.1
2	2.1	2.1	2.1
3	3.1	3.1	3.1
4	4.1	4.1	4.1
5	5.1	5.1	5.1
6	6.1	6.1	6.1
7	7.1	7.1	7.1
8	8.1	8.1	8.1
9	9.1	9.1	9.1
10	10.1	10.1	10.1
11	11.1	11.1	11.1
12	12.1	12.1	12.1
13	13.1	13.1	13.1
14	14.1	14.1	14.1
15	15.1	15.1	15.1
16	16.1	16.1	16.1
17	17.1	17.1	17.1
18	18.1	18.1	18.1
19	19.1	19.1	19.1
20	20.1	20.1	20.1
21	21.1	21.1	21.1
22	22.1	22.1	22.1
23	23.1	23.1	23.1
24	24.1	24.1	24.1
25	25.1	25.1	25.1
26	26.1	26.1	26.1
27	27.1	27.1	27.1
28	28.1	28.1	28.1
29	29.1	29.1	29.1
30	30.1	30.1	30.1
31	31.1	31.1	31.1
32	32.1	32.1	32.1
33	33.1	33.1	33.1
34	34.1	34.1	34.1
35	35.1	35.1	35.1
36	36.1	36.1	36.1
37	37.1	37.1	37.1
38	38.1	38.1	38.1
39	39.1	39.1	39.1
40	40.1	40.1	40.1
41	41.1	41.1	41.1
42	42.1	42.1	42.1
43	43.1	43.1	43.1
44	44.1	44.1	44.1
45	45.1	45.1	45.1
46	46.1	46.1	46.1
47	47.1	47.1	47.1
48	48.1	48.1	48.1
49	49.1	49.1	49.1
50	50.1	50.1	50.1
51	51.1	51.1	51.1
52	52.1	52.1	52.1
53	53.1	53.1	53.1
54	54.1	54.1	54.1
55	55.1	55.1	55.1
56	56.1	56.1	56.1
57	57.1	57.1	57.1
58	58.1	58.1	58.1
59	59.1	59.1	59.1
60	60.1	60.1	60.1
61	61.1	61.1	61.1
62	62.1	62.1	62.1
63	63.1	63.1	63.1
64	64.1	64.1	64.1
65	65.1	65.1	65.1
66	66.1	66.1	66.1
67	67.1	67.1	67.1
68	68.1	68.1	68.1
69	69.1	69.1	69.1
70	70.1	70.1	70.1
71	71.1	71.1	71.1
72	72.1	72.1	72.1
73	73.1	73.1	73.1
74	74.1	74.1	74.1
75	75.1	75.1	75.1
76	76.1	76.1	76.1
77	77.1	77.1	77.1
78	78.1	78.1	78.1
79	79.1	79.1	79.1
80	80.1	80.1	80.1
81	81.1	81.1	81.1
82	82.1	82.1	82.1
83	83.1	83.1	83.1
84	84.1	84.1	84.1
85	85.1	85.1	85.1
86	86.1	86.1	86.1
87	87.1	87.1	87.1
88	88.1	88.1	88.1
89	89.1	89.1	89.1
90	90.1	90.1	90.1
91	91.1	91.1	91.1
92	92.1	92.1	92.1
93	93.1	93.1	93.1
94	94.1	94.1	94.1
95	95.1	95.1	95.1
96	96.1	96.1	96.1
97	97.1	97.1	97.1
98	98.1	98.1	98.1
99	99.1	99.1	99.1
100	100.1	100.1	100.1



Project  
Epsom Rd  
94 - 104 Epsom Road, Zeland

Drawing Name  
Floor Plan - Parking Level 1



Date	17.03.2020	Scale	1:200	Sheet Size	A1
Drawn	CH	CHK	NH		
BR	NH				
Sub No.		Drawn No.		Revision	
5997	DA-0199			/ 10	

3B Architects  
400 Crown Street  
Sydney NSW 2000  
2010 Australia  
P 61 2 9389 9622  
www.3b.com.au



**FOR APPROVAL**

Rev	Date	Revision	By	CHK.
1	31.05.2019	ISSUED FOR CLIENT REVIEW	BR	NH
2	21.06.2019	ISSUES FOR COORDINATION	BR	NH
3	25.08.2019	ISSUED FOR INFORMATION	BR	NH
4	28.08.2019	ISSUED FOR DA	BR	NH
5	29.08.2019	ISSUED FOR DA	BR	NH
6	22.07.2019	ISSUED FOR DA	BR	NH
7	26.07.2019	FINAL ISSUE FOR DA	BR	NH
8	18.10.2019	AMENDED DA ISSUE	BR	NH
9	16.12.2019	ISSUED FOR INFORMATION	MS	ND
10	14.02.2020	ISSUE FOR INFORMATION	ND	ND
11	17.03.2020	ISSUED FOR COORDINATION	ND	ND

Nominated Architects: Adam Haddow+7188 | John Pradel-7004

Paving Schedule			
LEVEL	BUILDING	PAVING TIME	COUNT
A-1	BUILDING A	ACCESSIBLE	19
A-1	BUILDING A	CAR WASH	1
A-1	BUILDING A	STANDARD	66
A-1	BUILDING A	TRUCK	1
A-1	BUILDING A	TRUCK	15
			108
A-1	BUILDING A	CAR WASH	1
A-1	BUILDING A	MOTORCYCLE	9
A-2	BUILDING A	ST-4	2
A-2	BUILDING A	ST-2	1
A-2	BUILDING A	STANDARD	7

Class 33 Bile Stamps		
	SELLING TYPE	COUNT
BALE 10 A	C	133
BALE 10 B	C	144
BALE 10 C	C	145
BALE 10 D	C	146
BALE 10 E	C	147
BALE 10 F	C	148
BALE 10 G	C	149
BALE 10 H	C	150
BALE 10 I	C	151
BALE 10 J	C	152
BALE 10 K	C	153
BALE 10 L	C	154
BALE 10 M	C	155
BALE 10 N	C	156
BALE 10 O	C	157
BALE 10 P	C	158
BALE 10 Q	C	159
BALE 10 R	C	160
BALE 10 S	C	161
BALE 10 T	C	162
BALE 10 U	C	163
BALE 10 V	C	164
BALE 10 W	C	165
BALE 10 X	C	166
BALE 10 Y	C	167
BALE 10 Z	C	168
BALE 10 AA	C	169
BALE 10 AB	C	170
BALE 10 AC	C	171
BALE 10 AD	C	172
BALE 10 AE	C	173
BALE 10 AF	C	174
BALE 10 AG	C	175
BALE 10 AH	C	176
BALE 10 AI	C	177
BALE 10 AJ	C	178
BALE 10 AK	C	179
BALE 10 AL	C	180
BALE 10 AM	C	181
BALE 10 AN	C	182
BALE 10 AO	C	183
BALE 10 AP	C	184
BALE 10 AQ	C	185
BALE 10 AR	C	186
BALE 10 AS	C	187
BALE 10 AT	C	188
BALE 10 AU	C	189
BALE 10 AV	C	190
BALE 10 AW	C	191
BALE 10 AX	C	192
BALE 10 AY	C	193
BALE 10 AZ	C	194
BALE 10 BA	C	195
BALE 10 BB	C	196
BALE 10 BC	C	197
BALE 10 BD	C	198
BALE 10 BE	C	199
BALE 10 BF	C	200
BALE 10 BG	C	201
BALE 10 BH	C	202
BALE 10 BI	C	203
BALE 10 BJ	C	204
BALE 10 BK	C	205
BALE 10 BL	C	206
BALE 10 BM	C	207
BALE 10 BN	C	208
BALE 10 BO	C	209
BALE 10 BP	C	210
BALE 10 BQ	C	211
BALE 10 BR	C	212
BALE 10 BS	C	213
BALE 10 BT	C	214
BALE 10 BU	C	215
BALE 10 BV	C	216
BALE 10 BW	C	217
BALE 10 BX	C	218
BALE 10 BY	C	219
BALE 10 BZ	C	220
BALE 10 CA	C	221
BALE 10 CB	C	222
BALE 10 CC	C	223
BALE 10 CD	C	224
BALE 10 CE	C	225
BALE 10 CF	C	226
BALE 10 CG	C	227
BALE 10 CH	C	228
BALE 10 CI	C	229
BALE 10 CJ	C	230
BALE 10 CK	C	231
BALE 10 CL	C	232
BALE 10 CM	C	233
BALE 10 CN	C	234
BALE 10 CO	C	235
BALE 10 CP	C	236
BALE 10 CQ	C	237
BALE 10 CR	C	238
BALE 10 CS	C	239
BALE 10 CT	C	240
BALE 10 CU	C	241
BALE 10 CV	C	242
BALE 10 CW	C	243
BALE 10 CX	C	244
BALE 10 CY	C	245
BALE 10 CZ	C	246
BALE 10 DA	C	247
BALE 10 DB	C	248
BALE 10 DC	C	249
BALE 10 DD	C	250
BALE 10 DE	C	251
BALE 10 DF	C	252
BALE 10 DG	C	253
BALE 10 DH	C	254
BALE 10 DI	C	255
BALE 10 DJ	C	256
BALE 10 DK	C	257
BALE 10 DL	C	258
BALE 10 DM	C	259
BALE 10 DN	C	260
BALE 10 DO	C	261
BALE 10 DP	C	262
BALE 10 DQ	C	263
BALE 10 DR	C	264
BALE 10 DS	C	265
BALE 10 DT	C	266
BALE 10 DU	C	267
BALE 10 DV	C	268
BALE 10 DW	C	269
BALE 10 DX	C	270
BALE 10 DY	C	271
BALE 10 DZ	C	272
BALE 10 EA	C	273
BALE 10 EB	C	274
BALE 10 EC	C	275
BALE 10 ED	C	276
BALE 10 EE	C	277
BALE 10 EF	C	278
BALE 10 EG	C	279
BALE 10 EH	C	280
BALE 10 EI	C	281
BALE 10 EJ	C	282
BALE 10 EK	C	283
BALE 10 EL	C	284
BALE 10 EM	C	285
BALE 10 EN	C	286
BALE 10 EO	C	287
BALE 10 EP	C	288
BALE 10 EQ	C	289
BALE 10 ER	C	290
BALE 10 ES	C	291
BALE 10 ET	C	292
BALE 10 EU	C	293
BALE 10 EV	C	294
BALE 10 EW	C	295
BALE 10 EX	C	296
BALE 10 EY	C	297
BALE 10 EZ	C	298
BALE 10 FA	C	299
BALE 10 FB	C	300
BALE 10 FC	C	301
BALE 10 FD	C	302
BALE 10 FE	C	303
BALE 10 FF	C	304
BALE 10 FG	C	305
BALE 10 FH	C	306
BALE 10 FI	C	307
BALE 10 FJ	C	308
BALE 10 FK	C	309
BALE 10 FL	C	310
BALE 10 FM	C	311
BALE 10 FN	C	312
BALE 10 FO	C	313
BALE 10 FP	C	314
BALE 10 FQ	C	315
BALE 10 FR	C	316
BALE 10 FS	C	317
BALE 10 FT	C	318
BALE 10 FU	C	319
BALE 10 FV	C	320
BALE 10 FW	C	321
BALE 10 FX	C	322
BALE 10 FY	C	323
BALE 10 FZ	C	324
BALE 10 GA	C	325
BALE 10 GB	C	326
BALE 10 GC	C	327
BALE 10 GD	C	328
BALE 10 GE	C	329
BALE 10 GF	C	330
BALE 10 GG	C	331
BALE 10 GH	C	332
BALE 10 GI	C	333
BALE 10 GJ	C	334
BALE 10 GK	C	335
BALE 10 GL	C	336
BALE 10 GM	C	337
BALE 10 GN	C	338
BALE 10 GO	C	339
BALE 10 GP	C	340
BALE 10 GQ	C	341
BALE 10 GR	C	342
BALE 10 GS	C	343
BALE 10 GT	C	344
BALE 10 GU	C	345
BALE 10 GV	C	346
BALE 10 GW	C	347
BALE 10 GX	C	348
BALE 10 GY	C	349
BALE 10 GZ	C	350
BALE 10 HA	C	351
BALE 10 HB	C	352
BALE 10 HC	C	353
BALE 10 HD	C	354
BALE 10 HE	C	355
BALE 10 HF	C	356
BALE 10 HG	C	357
BALE 10 HH	C	358
BALE 10 HI	C	359
BALE 10 HJ	C	360
BALE 10 HK	C	361
BALE 10 HL	C	362
BALE 10 HM	C	363
BALE 10 HN	C	364
BALE 10 HO	C	365
BALE 10 HP	C	366
BALE 10 HQ	C	367
BALE 10 HR	C	368
BALE 10 HS	C	369
BALE 10 HT	C	370
BALE 10 HU	C	371
BALE 10 HV	C	372
BALE 10 HW	C	373
BALE 10 HX	C	374
BALE 10 HY	C	375
BALE 10 HZ	C	376
BALE 10 IA	C	377
BALE 10 IB	C	378
BALE 10 IC	C	379
BALE 10 ID	C	380
BALE 10 IE	C	381
BALE 10 IF	C	382
BALE 10 IG	C	383
BALE 10 IH	C	384
BALE 10 II	C	385
BALE 10 IJ	C	386
BALE 10 IK	C	387
BALE 10 IL	C	388
BALE 10 IM	C	389
BALE 10 IN	C	390
BALE 10 IO	C	391
BALE 10 IP	C	392
BALE 10 IQ	C	393
BALE 10 IR	C	394
BALE 10 IS	C	395
BALE 10 IT	C	396
BALE 10 IU	C	397
BALE 10 IV	C	398
BALE 10 IW	C	399
BALE 10 IX	C	400
BALE 10 IY	C	401
BALE 10 IZ	C	402
BALE 10 JA	C	403
BALE 10 JB	C	404
BALE 10 JC	C	405
BALE 10 JD	C	406
BALE 10 JE	C	407
BALE 10 JF	C	408
BALE 10 JG	C	409
BALE 10 JH	C	410
BALE 10 JI	C	411
BALE 10 JJ	C	412
BALE 10 JK	C	413
BALE 10 JL	C	414
BALE 10 JM	C	415
BALE 10 JN	C	416
BALE 10 JO	C	417
BALE 10 JP	C	418
BALE 10 JQ	C	419
BALE 10 JR	C	420
BALE 10 JS	C	421
BALE 10 JT	C	422
BALE 10 JU	C	423
BALE 10 JV	C	424
BALE 10 JW	C	425
BALE 10 JX	C	426
BALE 10 JY	C	427
BALE 10 JZ	C	428
BALE 10 KA	C	429
BALE 10 KB	C	430
BALE 10 KC	C	431
BALE 10 KD	C	432
BALE 10 KE	C	433
BALE 10 KF	C	434
BALE 10 KG	C	435
BALE 10 KH	C	436
BALE 10 KI	C	437
BALE 10 KJ	C	438
BALE 10 KK	C	439
BALE 10 KL	C	440
BALE 10 KM	C	441
BALE 10 KN	C	442
BALE 10 KO	C	443
BALE 10 KP	C	444
BALE 10 KQ	C	445
BALE 10 KR	C	446
BALE 10 KS	C	447
BALE 10 KT	C	448
BALE 10 KU	C	449
BALE 10 KV	C	450
BALE 10 KW	C	451
BALE 10 KX	C	452
BALE 10 KY	C	453
BALE 10 KZ	C	454
BALE 10 LA	C	455
BALE 10 LB	C	456
BALE 10 LC	C	457
BALE 10 LD	C	458
BALE 10 LE	C	459
BALE 10 LF	C	460
BALE 10 LG	C	461
BALE 10 LH	C	462
BALE 10 LI	C	463
BALE 10 LJ	C	464
BALE 10 LK	C	465
BALE 10 LL	C	466
BALE 10 LM	C	467
BALE 10 LN	C	468
BALE 10 LO	C	469
BALE 10 LP	C	470
BALE 10 LQ	C	471
BALE 10 LR	C	472
BALE 10 LS	C	473
BALE 10 LT	C	474
BALE 10 LU	C	475
BALE 10 LV	C	476
BALE 10 LW	C	477
BALE 10 LX	C	478
BALE 10 LY	C	479
BALE 10 LZ	C	480
BALE 10 MA	C	481
BALE 10 MB	C	482
BALE 10 MC	C	483
BALE 10 MD	C	484
BALE 10 ME	C	485
BALE 10 MF	C	486
BALE 10 MG	C	487
BALE 10 MH	C	488
BALE 10 MI	C	489
BALE 10 MJ	C	490
BALE 10 MK	C	491
BALE 10 ML	C	492
BALE 10 MM	C	493
BALE 10 MN	C	494
BALE 10 MO	C	495
BALE 10 MP	C	496
BALE 10 MQ	C	497
BALE 10 MR	C	498
BALE 10 MS	C	499
BALE 10 MT	C	500
BALE 10 MU	C	501
BALE 10 MV	C	502
BALE 10 MW	C	503
BALE 10 MX	C	504
BALE 10 MY	C	505
BALE 10 MZ	C	506
BALE 10 NA	C	507
BALE 10 NB	C	508
BALE 10 NC	C	509
BALE 10 ND	C	510
BALE 10 NE	C	511
BALE 10 NF	C	512
BALE 10 NG	C	513
BALE 10 NH	C	514
BALE 10 NI	C	515
BALE 10 NJ	C	516
BALE 10 NK	C	517
BALE 10 NL	C	518
BALE 10 NM	C	519
BALE 10 NN	C	520
BALE 10 NO	C	521
BALE 10 NP	C	522
BALE 10 NQ	C	523
BALE 10 NR	C	524
BALE 10 NS	C	525
BALE 10 NT	C	526
BALE 10 NU	C	527
BALE 10 NV	C	528
BALE 10 NW	C	529
BALE 10 NX	C	530
BALE 10 NY	C	531
BALE 10 NZ	C	532
BALE 10 OA	C	533
BALE 10 OB	C	534
BALE 10 OC	C	535
BALE 10 OD	C	536
BALE 10 OE	C	537
BALE 10 OF	C	538
BALE 10 OG	C	539
BALE 10 OH	C	540
BALE 10 OI	C	541
BALE 10 OJ	C	542
BALE 10 OK	C	543
BALE 10 OL	C	544
BALE 10 OM	C	545
BALE 10 ON	C	546
BALE 10 OO	C	547
BALE 10 OP	C	548
BALE 10 OQ	C	549
BALE 10 OR	C	550
BALE 10 OS	C	551
BALE 10 OT	C	552
BALE 10 OU	C	553
BALE 10 OV	C	554
BALE 10 OW	C	555
BALE 10 OX	C	556
BALE 10 OY	C	557
BALE 10 OZ	C	558
BALE 10 PA	C	559
BALE 10 PB	C	560
BALE 10 PC	C	561
BALE 10 PD	C	562
BALE 10 PE	C	563
BALE 10 PF	C	564
BALE 10 PG	C	565
BALE 10 PH	C	566
BALE 10 PI	C	567
BALE 10 PJ	C	568
BALE 10 PK	C	569
BALE 10 PL	C	570
BALE 10 PM	C	571
BALE 10 PN	C	572
BALE 10 PO	C	573
BALE 10 PP	C	574
BALE 10 PQ	C	575
BALE 10 PR	C	576
BALE 10 PS	C	577
BALE 10 PT	C	578
BALE 10 PU	C	579
BALE 10 PV	C	580
BALE 10 PW	C	581
BA		

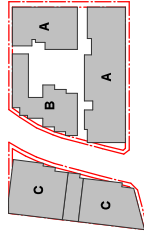

Client



Project

1	2	3	4	5	6	7	8	9	10	11	12	13	14	15	16	17	18	19	20	21	22	23	24	25	26	27	28	29	30	31	32	33	34	35	36	37	38	39	40	41	42	43	44	45	46	47	48	49	50	51	52	53	54	55	56	57	58	59	60	61	62	63	64	65	66	67	68	69	70	71	72	73	74	75	76	77	78	79	80	81	82	83	84	85	86	87	88	89	90	91	92	93	94	95	96	97	98	99	100	101	102	103	104	105	106	107	108	109	110	111	112	113	114	115	116	117	118	119	120	121	122	123	124	125	126	127	128	129	130	131	132	133	134	135	136	137	138	139	140	141	142	143	144	145	146	147	148	149	150	151	152	153	154	155	156	157	158	159	160	161	162	163	164	165	166	167	168	169	170	171	172	173	174	175	176	177	178	179	180	181	182	183	184	185	186	187	188	189	190	191	192	193	194	195	196	197	198	199	200	201	202	203	204	205	206	207	208	209	210	211	212	213	214	215	216	217	218	219	220	221	222	223	224	225	226	227	228	229	230	231	232	233	234	235	236	237	238	239	240	241	242	243	244	245	246	247	248	249	250	251	252	253	254	255	256	257	258	259	260	261	262	263	264	265	266	267	268	269	270	271	272	273	274	275	276	277	278	279	280	281	282	283	284	285	286	287	288	289	290	291	292	293	294	295	296	297	298	299	300	301	302	303	304	305	306	307	308	309	310	311	312	313	314	315	316	317	318	319	320	321	322	323	324	325	326	327	328	329	330	331	332	333	334	335	336	337	338	339	340	341	342	343	344	345	346	347	348	349	350	351	352	353	354	355	356	357	358	359	360	361	362	363	364	365	366	367	368	369	370	371	372	373	374	375	376	377	378	379	380	381	382	383	384	385	386	387	388	389	390	391	392	393	394	395	396	397	398	399	400	401	402	403	404	405	406	407	408	409	410	411	412	413	414	415	416	417	418	419	420	421	422	423	424	425	426	427	428	429	430	431	432	433	434	435	436	437	438	439	440	441	442	443	444	445	446	447	448	449	450	451	452	453	454	455	456	457	458	459	460	461	462	463	464	465	466
---	---	---	---	---	---	---	---	---	----	----	----	----	----	----	----	----	----	----	----	----	----	----	----	----	----	----	----	----	----	----	----	----	----	----	----	----	----	----	----	----	----	----	----	----	----	----	----	----	----	----	----	----	----	----	----	----	----	----	----	----	----	----	----	----	----	----	----	----	----	----	----	----	----	----	----	----	----	----	----	----	----	----	----	----	----	----	----	----	----	----	----	----	----	----	----	----	----	----	-----	-----	-----	-----	-----	-----	-----	-----	-----	-----	-----	-----	-----	-----	-----	-----	-----	-----	-----	-----	-----	-----	-----	-----	-----	-----	-----	-----	-----	-----	-----	-----	-----	-----	-----	-----	-----	-----	-----	-----	-----	-----	-----	-----	-----	-----	-----	-----	-----	-----	-----	-----	-----	-----	-----	-----	-----	-----	-----	-----	-----	-----	-----	-----	-----	-----	-----	-----	-----	-----	-----	-----	-----	-----	-----	-----	-----	-----	-----	-----	-----	-----	-----	-----	-----	-----	-----	-----	-----	-----	-----	-----	-----	-----	-----	-----	-----	-----	-----	-----	-----	-----	-----	-----	-----	-----	-----	-----	-----	-----	-----	-----	-----	-----	-----	-----	-----	-----	-----	-----	-----	-----	-----	-----	-----	-----	-----	-----	-----	-----	-----	-----	-----	-----	-----	-----	-----	-----	-----	-----	-----	-----	-----	-----	-----	-----	-----	-----	-----	-----	-----	-----	-----	-----	-----	-----	-----	-----	-----	-----	-----	-----	-----	-----	-----	-----	-----	-----	-----	-----	-----	-----	-----	-----	-----	-----	-----	-----	-----	-----	-----	-----	-----	-----	-----	-----	-----	-----	-----	-----	-----	-----	-----	-----	-----	-----	-----	-----	-----	-----	-----	-----	-----	-----	-----	-----	-----	-----	-----	-----	-----	-----	-----	-----	-----	-----	-----	-----	-----	-----	-----	-----	-----	-----	-----	-----	-----	-----	-----	-----	-----	-----	-----	-----	-----	-----	-----	-----	-----	-----	-----	-----	-----	-----	-----	-----	-----	-----	-----	-----	-----	-----	-----	-----	-----	-----	-----	-----	-----	-----	-----	-----	-----	-----	-----	-----	-----	-----	-----	-----	-----	-----	-----	-----	-----	-----	-----	-----	-----	-----	-----	-----	-----	-----	-----	-----	-----	-----	-----	-----	-----	-----	-----	-----	-----	-----	-----	-----	-----	-----	-----	-----	-----	-----	-----	-----	-----	-----	-----	-----	-----	-----	-----	-----	-----	-----	-----	-----	-----	-----	-----	-----	-----	-----	-----	-----	-----	-----	-----	-----	-----	-----	-----	-----	-----	-----	-----	-----	-----	-----	-----	-----	-----	-----	-----	-----	-----	-----	-----	-----	-----	-----	-----	-----	-----	-----	-----	-----	-----	-----	-----	-----	-----	-----	-----	-----	-----

94 - 104 Ensom Road Zettland  
Epsom Rd

Danzon, N. M.

Floor Plan 1 and 4 (Continued)



Date	Scale	Sheet Size
17.03.2020	1 : 200	@ A1

Drawn	Chk.
BR	NH

Job No. 5997      Drawing No. DA-0200      Revision 112

**SJB Architects**  
Level 2  
490 Crown Street  
Surry Hills NSW  
2010 Australia  
T 61 2 9380 991  
F 61 2 9380 992  
www.sjb.com.au

1 LEVEL 1 (GROUND)  
1: 200@A1



**FOR APPROVAL**

Rev	Date	Revision	By	Chk.
31.05.2019	ISSUED FOR CLIENT REVIEW	BR	NH	
21.06.2019	ISSUES FOR COORDINATION	BR	NH	
25.06.2019	ISSUES FOR INFORMATION	BR	NH	
25.06.2019	ISSUED FOR DA	BR	NH	
25.06.2019	ISSUED FOR DA	BR	NH	
22.07.2019	ISSUED FOR DA	BR	NH	
26.07.2019	FINAL ISSUE FOR DA	BR	NH	
18.10.2019	AMENDED DA ISSUE	BR	NH	
18.12.2019	ISSUES FOR INFORMATION	MS	ND	
14.02.2020	ISSUE FOR INFORMATION	N.D.	N.D.	

Nominated Architects: Adam Haddow-7188 | John Pradel-7004

ite Key

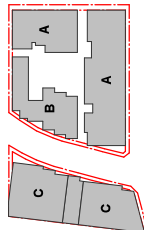

Client



Project

Page 14

94 - 104 Epsom Road, Zetland

Drawing Name:

Floor Plan - Level 2



Date	Scale	Sheet Size
14.02.2020	1 : 200	@ A1
Drawn	CHK	
BR	NH	

Job No. 5997      Drawing No. DA-0201      Revision 1/10

**SJB Architects**  
Level 2  
590 Crown Street  
Sunny Hills NSW  
2010 Australia  
T 61 2 9380 9911  
F 61 2 9380 9922  
[www.sjb.com.au](http://www.sjb.com.au)

1  
0502  
LEVEL 2  
1:200@A1

**FOR APPROVAL**

Rev	Date	Revision	By	Chk.
	31.05.2019	ISSUED FOR CLIENT REVIEW	BR	NH
	21.06.2019	ISSUES FOR COORDINATION	BR	NH
	25.06.2019	ISSUED FOR INFORMATION	BR	NH
	28.06.2019	ISSUED FOR DA	BR	NH
	03.07.2019	ISSUED FOR DA	BR	NH
	22.07.2019	ISSUED FOR DA	BR	NH
	26.07.2019	FINAL ISSUE FOR DA	BR	NH
	18.10.2019	ADDITIONAL ISSUE FOR INFORMATION	BR	NH
	14.02.2020	ISSUED FOR INFORMATION	BR	NH
	17.03.2020	ISSUE FOR COORDINATION	ND	ND

Nominated Architects: Adam Haddow-7188 | John Pradel-7004

ite Key

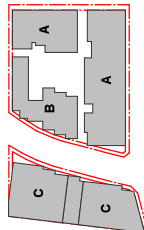

client



Project

FD-302a (Rev. 11-27-2010)

94 - 104 Epsom Road, Zetland

Drawing Name:

Floor Plan - Level 3



Date	Scale	Sheet Size
17 03 2020	1 : 200	A4

2046 JOURNAL OF CLIMATE

[illegible]

Job No.	Drawing No.	Revision
---------	-------------	----------

5997 DA-0202 / 11



**SJB Architects**  
Level 2  
150 Crown Street  
Sunny Hills NSW  
2010 Australia  
T 61 2 9380 9911  
F 61 2 9380 9922  
[www.sjb.com.au](http://www.sjb.com.au)

