

# TRAFFIC CONTROL PLAN EVELEIGH STREET - ROAD CLOSURE SECTION A - DAY WORKS

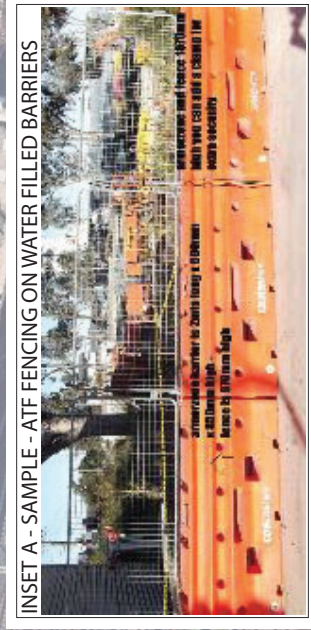

### NOTES:

1. ALL SIGNAGE TO BE INSTALLED IN ACCORDANCE WITH RMS "TRAFFIC CONTROL AT WORKSITES" MANUAL AND AS1742.3.
2. ALL SIGNAGE AND DELINEATION MUST BE INSTALLED BY RMS CERTIFIED TRAFFIC CONTROLLER(S) ONLY.
3. PEDESTRIAN ACCESS MAINTAINED ALONG EVELEIGH STREET PAST THE WORK AREA.
4. TRAVEL PATH ALONG EVELEIGH STREET MAINTAINED FOR USE BY EMERGENCY VEHICLES AS REQUIRED.
5. TRAFFIC CONTROL PLAN IMPLEMENTED IN CONJUNCTION WITH DETOUR PLAN SBMG01789-129.

| DATE | DESCRIPTION        |
|------|--------------------|
| E    |                    |
| D    |                    |
| C    |                    |
| B    |                    |
| A    | INITIAL SUBMISSION |

|   |                              |                     |
|---|------------------------------|---------------------|
| PREPARED BY: MATTHEW YOUNG<br>RMS PREPARE A WORKZONE<br>TRAFFIC MANAGEMENT PLAN<br>CERTIFICATE NO. 0057178986 |                              |                     |
| SIGNED:   |                              |                     |
| Project/Event:  | THE PEMULWUY PRECINCT        | SCALE: NOT TO SCALE |
| Location:   | EVELEIGH STREET, REDFERN NSW |                     |
| Client:   | DEICORP                      |                     |
| Plan No.  | SBMG01789-127                |                     |
| Date:   | 16TH OCTOBER 2020            |                     |

SBMG PLANNING  
 34/36 WILSON STREET  
 SYDNEY NSW 2000  
 PH: 0467 370 380  
 WWW.SBMGPLANNING.COM.AU  
 EMAIL: matt@sbmgplanning.com.au

# TRAFFIC CONTROL PLAN EVELEIGH STREET - ROAD CLOSURE SECTION A - AFTERCARE



**LEGEND:**

- TRAFFIC FLOW
- SITE BOUNDARY
- WORK AREA
- WATER FILLED BARRIERS (WITH TEMPORARY FENCING (SEE INSET))
- PEDESTRIAN ROUTE
- TRAFFIC CONTROLLER



**NOTES:**

1. ALL SIGNAGE TO BE INSTALLED IN ACCORDANCE WITH RMS "TRAFFIC CONTROL AT WORKSITES" MANUAL AND AS1742.3.
2. ALL SIGNAGE AND DELINEATION MUST BE INSTALLED BY RMS CERTIFIED TRAFFIC CONTROLLER(S) ONLY.
3. PEDESTRIAN ACCESS MAINTAINED ALONG EVELEIGH STREET PAST THE WORK AREA.
4. LOCAL ACCESS MAINTAINED TO SURROUNDING PROPERTIES.
5. TRAFFIC CONTROL PLAN IMPLEMENTED IN CONJUNCTION WITH DETOUR PLAN SBMG01789-129.

| DATE | DESCRIPTION        |
|------|--------------------|
| E    |                    |
| D    |                    |
| C    |                    |
| B    |                    |
| A    | INITIAL SUBMISSION |

PREPARED BY: MATTHEW YOUNG  
RMS PREPARE A WORKZONE  
TRAFFIC MANAGEMENT PLAN  
CERTIFICATE NO. 0057178886

SIGNED:

|                              |                |
|------------------------------|----------------|
| THE PEMULWUY PRECINCT        | Project/Event: |
| EVELEIGH STREET, REDFERN NSW | Location:      |
| DEICORP                      | Client:        |
| SBMG01789-128                | Plan No.:      |
| A                            | Date:          |
| 16TH OCTOBER 2020            |                |

SCALE: NOT TO SCALE

SBMG  
PLANNING

www.sbmginforming.com.au  
matt@sbmginforming.com.au  
m: 0467 370 380

Project/Event: THE PEMULWUY PRECINCT  
Location: EVELEIGH STREET, REDFERN NSW  
Client: DEICORP  
Plan No. SBMG01789-128  
Date: 16TH OCTOBER 2020

# DETOUR PLAN EVELEIGH STREET - ROAD CLOSURE SECTION A

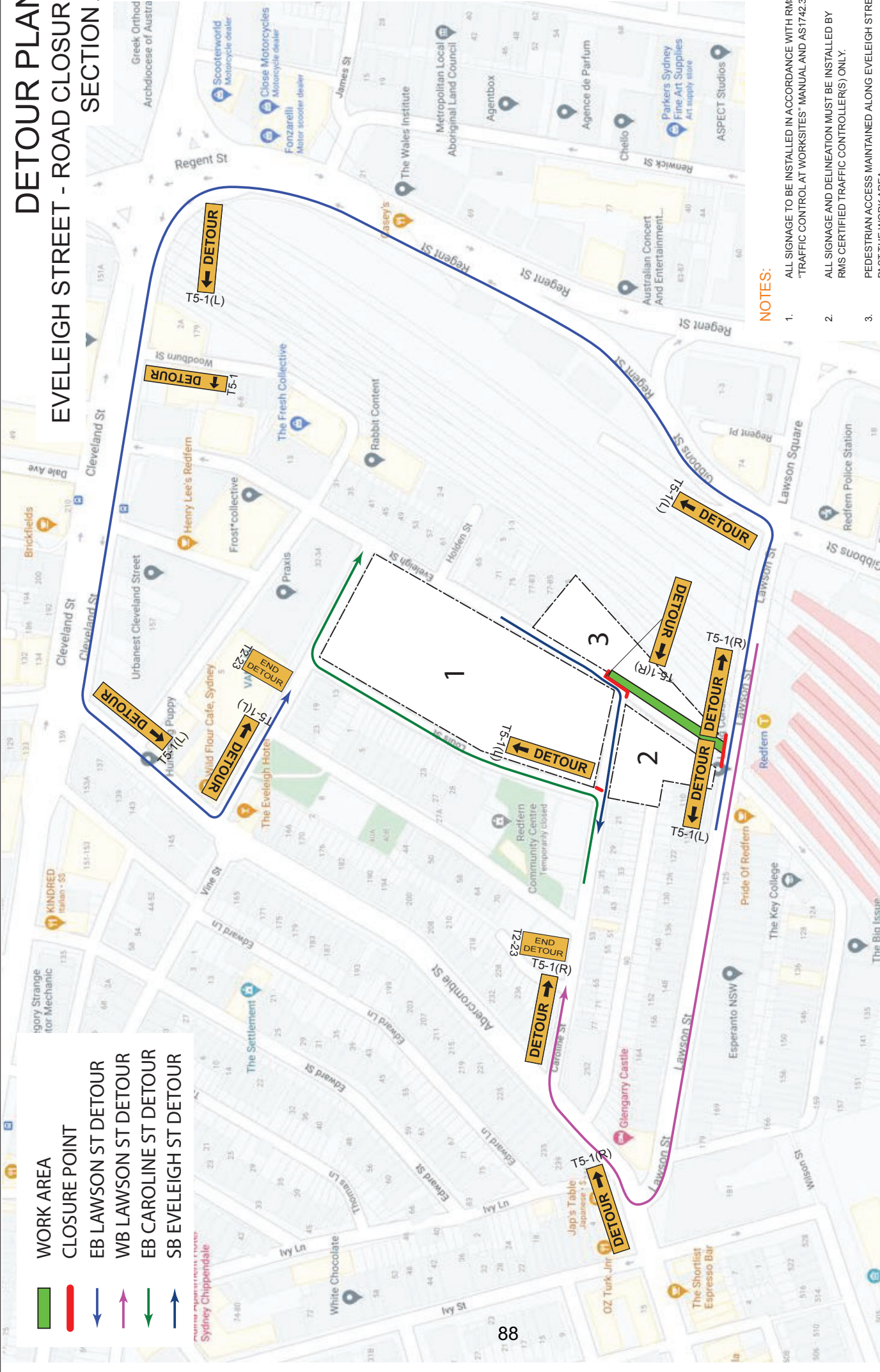

### NOTES:

1. ALL SIGNAGE TO BE INSTALLED IN ACCORDANCE WITH RMS "TRAFFIC CONTROL AT WORKSITES" MANUAL AND AS1742.3.
2. ALL SIGNAGE AND DELINEATION MUST BE INSTALLED BY RMS CERTIFIED TRAFFIC CONTROLLER(S) ONLY.
3. PEDESTRIAN ACCESS MAINTAINED ALONG EVELEIGH STREET PAST THE WORK AREA.
4. LOCAL ACCESS MAINTAINED TO SURROUNDING PROPERTIES.
5. DETOUR PLAN IMPLEMENTED IN CONJUNCTION WITH TRAFFIC CONTROL PLAN SBMG01789-127 & SBMG01789-128.

| DATE | DESCRIPTION        |
|------|--------------------|
| E    |                    |
| D    |                    |
| C    |                    |
| B    |                    |
| A    | INITIAL SUBMISSION |

PREPARED BY: MATTHEW YOUNG  
RMS PREPARE A WORKZONE  
TRAFFIC MANAGEMENT PLAN  
CERTIFICATE NO. 0057176886

SIGNED:

|                |                              |
|----------------|------------------------------|
| Project/Event: | THE PEMULWUY PRECINCT        |
| Location:      | EVELEIGH STREET, REDFERN NSW |
| Client:        | DEICORP                      |
| Plan No.       | SBMG01789-128                |
| Date:          | 16TH OCTOBER 2020            |

|                |                              |
|----------------|------------------------------|
| Project/Event: | THE PEMULWUY PRECINCT        |
| Location:      | EVELEIGH STREET, REDFERN NSW |
| Client:        | DEICORP                      |
| Plan No.       | SBMG01789-128                |
| Date:          | 16TH OCTOBER 2020            |

SBMG PLANNING

SBMG Pty Ltd  
ABN: 34 167 665 560  
www.sbmplanning.com.au  
matt@sbmplanning.com.au  
m: 0467 370 380

THE PEMULWUY PRECINCT  
EVELEIGH STREET, REDFERN NSW  
DEICORP  
SBMG01789-128  
16TH OCTOBER 2020

SCALE: NOT TO SCALE



# TRAFFIC CONTROL PLAN EVELEIGH STREET - ROAD CLOSURE SECTION B - AFTERCARE



1. ALL SIGNAGE TO BE INSTALLED IN ACCORDANCE WITH RMS "TRAFFIC CONTROL AT WORKSITES" MANUAL AND AS1742.3.
2. ALL SIGNAGE AND DELINEATION MUST BE INSTALLED BY RMS CERTIFIED TRAFFIC CONTROLLER(S) ONLY.
3. PEDESTRIAN ACCESS MAINTAINED ALONG EVELEIGH STREET PAST THE WORK AREA.
4. LOCAL ACCESS MAINTAINED TO SURROUNDING PROPERTIES.
5. TRAFFIC CONTROL PLAN IMPLEMENTED IN CONJUNCTION WITH DETOUR PLAN SBMG01789-132.

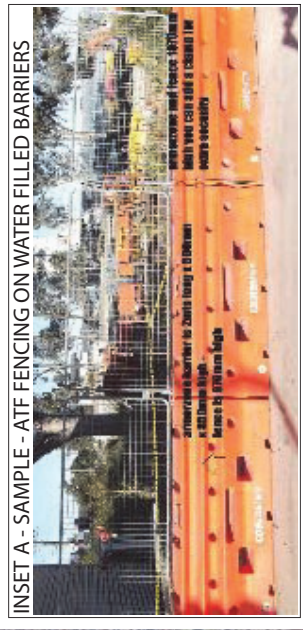

| DATE | DESCRIPTION        |
|------|--------------------|
| E    |                    |
| D    |                    |
| C    |                    |
| B    |                    |
| A    | INITIAL SUBMISSION |

PREPARED BY: MATTHEW YOUNG  
RMS PREPARE A WORKZONE  
TRAFFIC MANAGEMENT PLAN  
CERTIFICATE NO. 0057178986

SIGNED:

|                              |                |
|------------------------------|----------------|
| THE PEMULWUY PRECINCT        | Project/Event: |
| EVELEIGH STREET, REDFERN NSW | Location:      |
| DEICORP                      | Client:        |
| SBMG01789-131                | Plan No.       |
| A                            | Date:          |
| 16TH OCTOBER 2020            |                |

SBMG Pty Ltd  
ABN: 34 187 165 560  
www.sbmginforming.com.au  
matt@sbmgplanning.com.au  
m: 0467 370 380

SCALE: NOT TO SCALE

# DETOUR PLAN

## EVELEIGH STREET - ROAD CLOSURE

### SECTION B

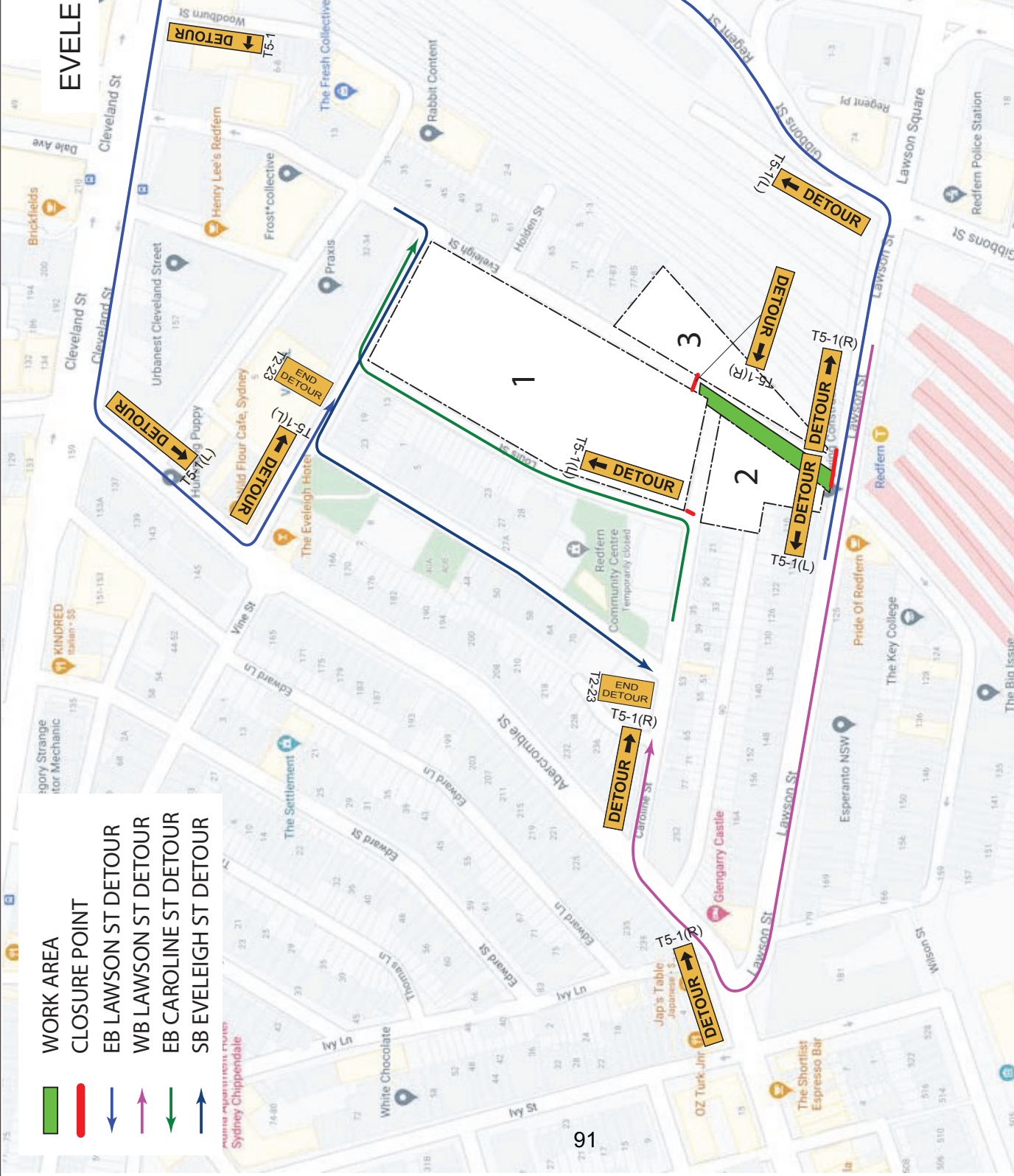

- █ WORK AREA
- █ CLOSURE POINT
- EB LAWSON ST DETOUR
- WB LAWSON ST DETOUR
- EB CAROLINE ST DETOUR
- SB EVELEIGH ST DETOUR

#### NOTES:

1. ALL SIGNAGE TO BE INSTALLED IN ACCORDANCE WITH RMS "TRAFFIC CONTROL AT WORKSITES" MANUAL AND AS1742.3.
2. ALL SIGNAGE AND DELINEATION MUST BE INSTALLED BY RMS CERTIFIED TRAFFIC CONTROLLER(S) ONLY.
3. PEDESTRIAN ACCESS MAINTAINED ALONG EVELEIGH STREET PAST THE WORK AREA.
4. LOCAL ACCESS MAINTAINED TO SURROUNDING PROPERTIES.
5. DETOUR PLAN IMPLEMENTED IN CONJUNCTION WITH TRAFFIC CONTROL PLAN SBMG01789-130 & SBMG01789-131.

| DATE | DESCRIPTION        |
|------|--------------------|
| E    |                    |
| D    |                    |
| C    |                    |
| B    |                    |
| A    | INITIAL SUBMISSION |

PREPARED BY: MATTHEW YOUNG  
 RMS PREPARE A WORKZONE  
 TRAFFIC MANAGEMENT PLAN  
 CERTIFICATE NO. 0057176886

SIGNED:

|                |                              |
|----------------|------------------------------|
| Project/Event: | THE PEMULWUY PRECINCT        |
| Location:      | EVELEIGH STREET, REDFERN NSW |
| Client:        | DEICORP                      |
| Plan No.       | SBMG01789-132                |
| Date:          | 16TH OCTOBER 2020            |

SBMG Pty Ltd  
 ABN: 34 167 665 560  
 www.sbmginforming.com.au  
 matt@sbmginforming.com.au  
 m: 0467 370 380

SCALE: NOT TO SCALE