

OWNER: WYNNWARD LANE, SOUTH LEINCHINGTON PROJECT, INVAIATION
DRAWN: Sarah Hession
CHECKED: Helen Hooper
DATE: 23/05/2024
PROJECT: WYNNWARD LANE, SOUTH LEINCHINGTON PROJECT, INVAIATION

STOP THE WORKS

NOTES: DRAWINGS NOT TO SCALE. ALL DIMENSIONS AND SPACINGS SHOWN ON THIS DRAWING ARE FOR INFORMATION ONLY. THE CONTRACTOR SHALL BE RESPONSIBLE FOR VERIFYING THE DIMENSIONS AND SPACINGS ON THE GROUND.

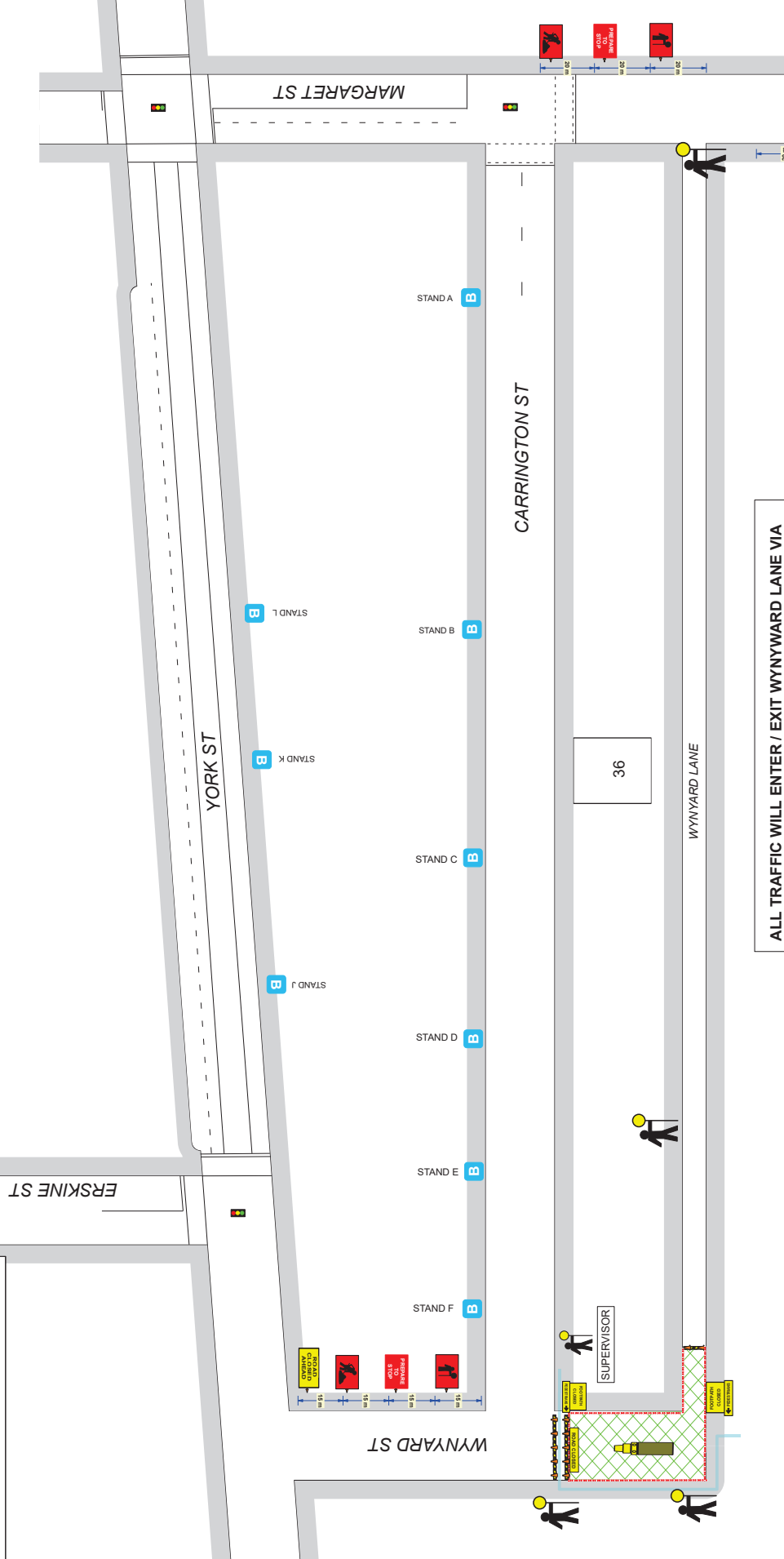

ALL TRAFFIC WILL ENTER / EXIT WYNNWARD LANE VIA MARGARET ST UNDER STOP/SLOW MAINTAINING ACCESS TO ALL DRIVEWAYS

- NOTES:
1. SPEED LIMIT 50KPH
 2. CONTAINMENT FENCE ERECTED AROUND WORKSITE.
 3. DELINEATION CONES PROVIDING 1.2m BUFFER ZONE

CONE SPACING

APPROXIMATE	APPROACH	SPACING
SPEED (KPH)	SPEED (KPH)	SPEED (KPH)
<50	<50	4

APPROX SPEED CONTROLLER POSITION	APPROX SPEED CONTROLLER TAPER	LATERAL SHIFT	MERGE TAPER
TRAFIC STOP	TRAFIC STOP	TRAFIC STOP	TRAFIC STOP
51-70	15	15	15
71-90	25	25	25
91-110	30	30	30
111-130	35	35	35
131-150	40	40	40
151-170	45	45	45
171-190	50	50	50
191-210	55	55	55
211-230	60	60	60
231-250	65	65	65
251-270	70	70	70
271-290	75	75	75
291-310	80	80	80
311-330	85	85	85
331-350	90	90	90
351-370	95	95	95
371-390	100	100	100