

Date: 11/07/21 **Author:** Gemini Perera **Project:** 28 Billyard Avenue, Elizabeth Bay
Client: Profile Property Group **Contact:** Simon Agostino **Phone:** 0432 821 448

www.invarion.com

Comments:

This plan was designed by Gemini Perera of Jim's Traffic Control - Hornsby in accordance with Australian Standards and the RMS's Traffic Control at Worksites Handbook V5.0. The plan is designed for the safe closure of a section Billyard Avenue at 28 Billyard Avenue, Elizabeth Bay for the mobile crane setup. During work traffic will be detoured and pedestrians will be assisted to the other footpath. Certified traffic controllers will be on-site to implement and monitor this TCP. All traffic control plans are copyright/property of Jim's Traffic Control - Hornsby and are not transferrable unless authorized by Jim's Traffic Control - Hornsby. Any questions please contact Dwayne Perera of Jim's Traffic Control - Hornsby on 0400 350 182.



Residents and Pedestrians will be safely guided around the work site as necessary

Manifest

- 18 x Cone
- 12 x Bollard
- 12 x Pedestrian Tape
- 10 x sign single
- 6 x Traffic Controller
- 3 x T1-18 PREPARE TO STOP
- 2 x T1-25 ROADWORK ON SIDE ROAD
- 2 x T1-34 TRAFFIC CONTROLLER AHEAD
- 2 x T1-6 DETOUR AHEAD
- 2 x T2-4 ROAD CLOSED
- 2 x T8-3 USE OTHER FOOTPATH
- 1 x RESIDENTS residents only
- 1 x T2-4-Q02a ROAD CLOSED AHEAD
- 1 x T5-1 (F) DETOUR IN FRONT
- 1 x T8-2L pedestrians (L)
- 1 x T8-2R pedestrians (R)
- 1 x TC1475 ROAD CLOSED

Legend

- Bollard
- Cone
- Driveway
- Job Site
- Mobile Crane
- Pedestrian Tape
- Traffic Controller
- tray truck
- Work Area

Signs Spacing's	
Estimated Speed Of Traffic (D)	Dimension Range
0-40km	0-5m
50km	15-50m
60km	45-60m
70km	70m
80km	80m
90km	90m
100km	100m

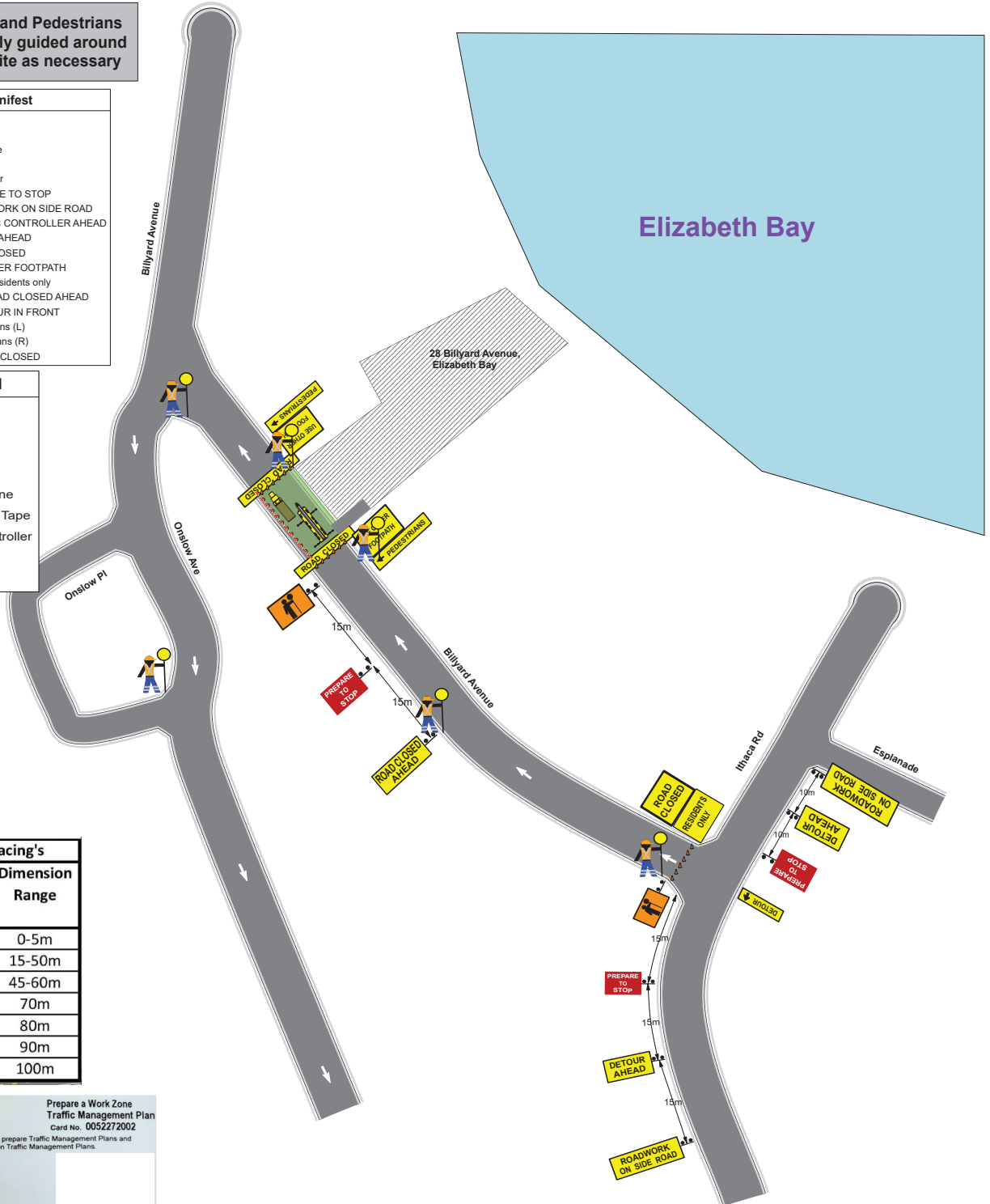

NSW Transport Roads & Maritime Services
 Prepare a Work Zone Traffic Management Plan
 Card No. 0052272002
 This qualification enables you to prepare Traffic Management Plans and conduct inspections on Traffic Management Plans.

GEMINI PERERA
 Expiry Date: 24/01/2023

This card is not a proof of identity.

PLAN NOT TO SCALE

Detour Routes

Legend	
	Traffic Controller
	VMS Board
	Work Area

Manifest	
8 x	Traffic Controller
5 x	sign single
3 x	T1-23 CHANGED TRAFFIC CONDITIONS
2 x	RESIDENTS residents only
2 x	T2-4 ROAD CLOSED
2 x	T5-1 (F) DETOUR IN FRONT
2 x	TM1-25C Roadwork On Side Road
1 x	T1-32 SIDE ROAD CLOSED
1 x	T1-6 DETOUR AHEAD
1 x	T5-1 (R) DETOUR LEFT
1 x	VMS Board



	Prepare a Work Zone Traffic Management Plan Card No. 0052272002
	This qualification enables you to prepare Traffic Management Plans and conduct inspections on Traffic Management Plans.
GEMINI PERERA	
Expiry Date: 24/01/2023	
<small>This card is not a proof of identity.</small>	

PLAN NOT TO SCALE