

Traffic Guidance Scheme:

Date: 17/10/2023 **Author:** Dwayne Perera **Project:** 90-102 Regent Street, Redfern
Client: Richard Crookes Construction **Contact:** Wayne Famlonga **Phone:** 0409 516 889

Comments:

This plan was designed by Dwayne Perera of Roadside Traffic Management in accordance with Australian Standards and the TfNSW's Traffic Control at Worksites Manual V6.1. The plan is designed for the safe closure of Marian Street between Gibbons and Regent Street, William Lane, the kerb lane on Regent Street and the kerb lane on Gibbons Street for the setup of a 300T mobile crane to remove the site tower crane at 90-102 Regent Street, Redfern. During work traffic and pedestrians will be detoured. Certified traffic controllers will be on-site to implement and monitor this TGS. All traffic guidance schemes are copyright/property of Roadside Traffic Management and are not transferrable unless authorized by Roadside Traffic Management. Any questions please contact Dwayne Perera of Roadside Traffic Management on 0400 350 182.



Manifest

- 193 x Cone
- 25 x Bollard
- 24 x Pedestrian Tape
- 14 x Traffic Controller
- 12 x ImLEFTARROW
- 8 x Semi Trailer
- 8 x sign single
- 6 x Traffic Light
- 5 x ImMERGERIGHT.tps
- 4 x ImCYCLES.MALL
- 2 x ImLEFTSTRAIGHT
- 2 x T1-18 PREPARE TO STOP
- 2 x T1-34 TRAFFIC CONTROLLER AHEAD
- 2 x T8-3 USE OTHER FOOTPATH
- 2 x TM5-V5 CHEVRON
- 1 x ImBUS
- 1 x Mobile Crane
- 1 x R4-212
- 1 x R4-225
- 1 x RESIDENTS residents only
- 1 x T1-5 WORKERS AHEAD
- 1 x T1-6 DETOUR AHEAD
- 1 x T2-4 ROAD CLOSED
- 1 x T5-1 (L) DETOUR LEFT
- 1 x T5-1 (R) DETOUR LEFT
- 1 x T8-2 (L) PEDESTRIANS LEFT
- 1 x T8-2 (R) PEDESTRIANS RIGHT
- 1 x W5-205 trucks turning

Legend

- Bollard
- Bus Stop
- Cone
- Job Site
- Mobile Crane
- Pedestrian Access
- Pedestrian Tape
- Tower Crane
- Traffic Controller
- Vehicle Access
- Vehicle Egress
- Vehicle Reverse
- Work Area

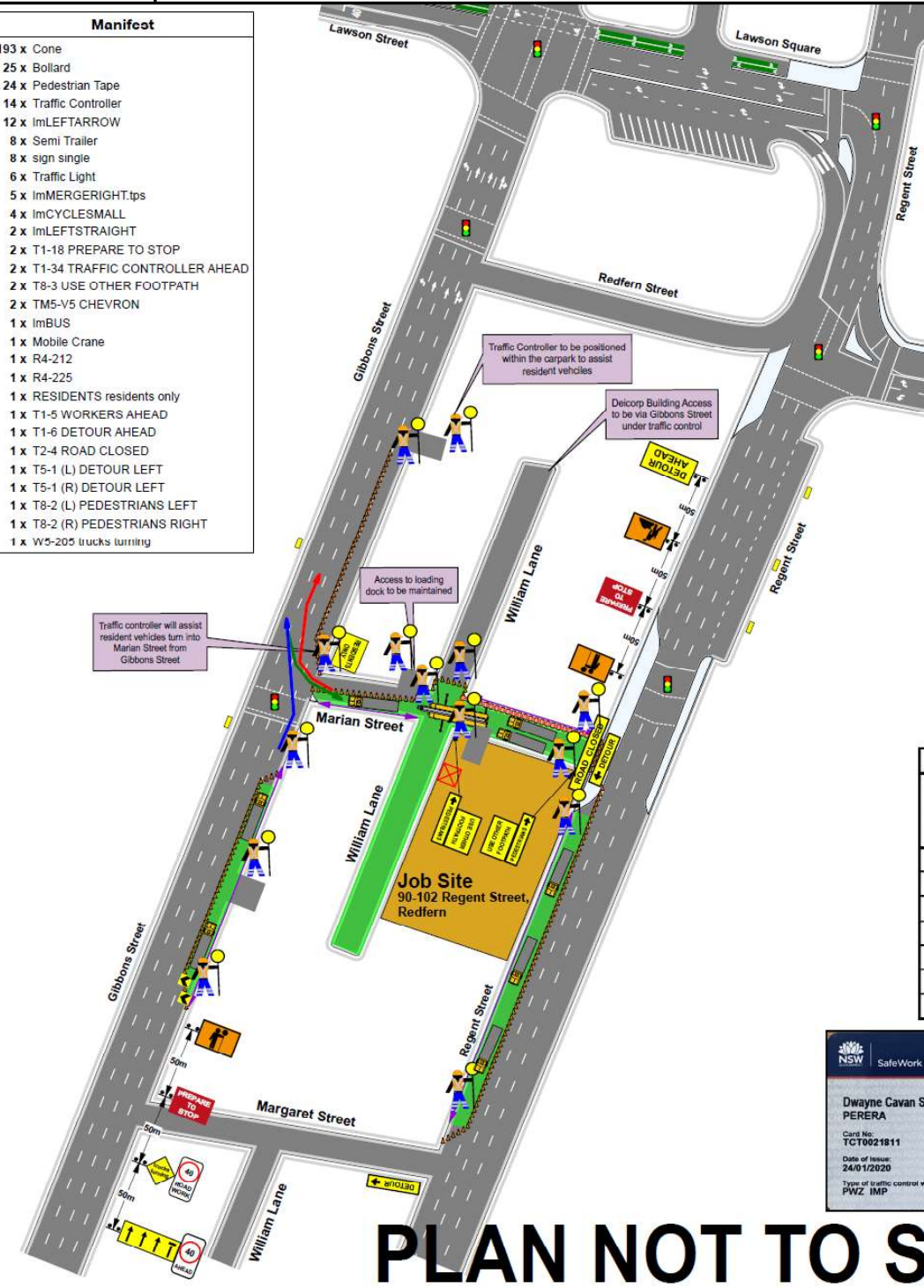

Signs Spacing's

Estimated Speed Of Traffic (D)	Dimension Range
0-40km	0-5m
50km	15-50m
60km	45-60m
70km	70m
80km	80m
90km	90m
100km	100m

NSW SafeWork NSW WORK HEALTH & SAFETY TRAFFIC CONTROL WORK

Dwayne Cavan Shanahan
PERERA

Card No: TCT0021811 D.O.B: 15/08/1995

Date of Issue: 24/01/2020

Type of traffic control work: PVZ IMP

NEW SOUTH WALES

PLAN NOT TO SCALE